

°on line

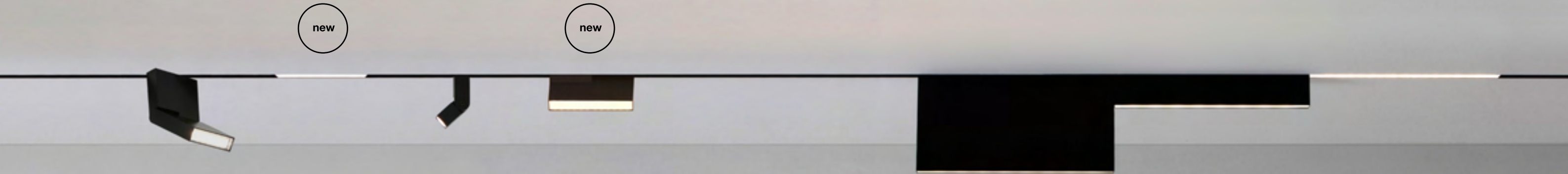

The power of this light source lies in its slenderness and unobtrusiveness; the simplicity of the fixtures' design makes that it can be used anywhere. It can be built-in, surface mounted or hung from the ceiling. An innovative and state-of-the-art magnet and contact system makes that a wide variety of LED-fixtures can be inserted or moved.

The LED-fixtures are similar in style yet each one of them has its own character and lighting quality: a mini spotlight 'dot', built-in or surface mounted strips 'in', 'in small' and 'out'. Directable pliable sheets called 'knick' and 'knick small'. 'turn' is a rotating & pliable spot. Get on line!



°knick small & knick





°in small & in





°out





°dot

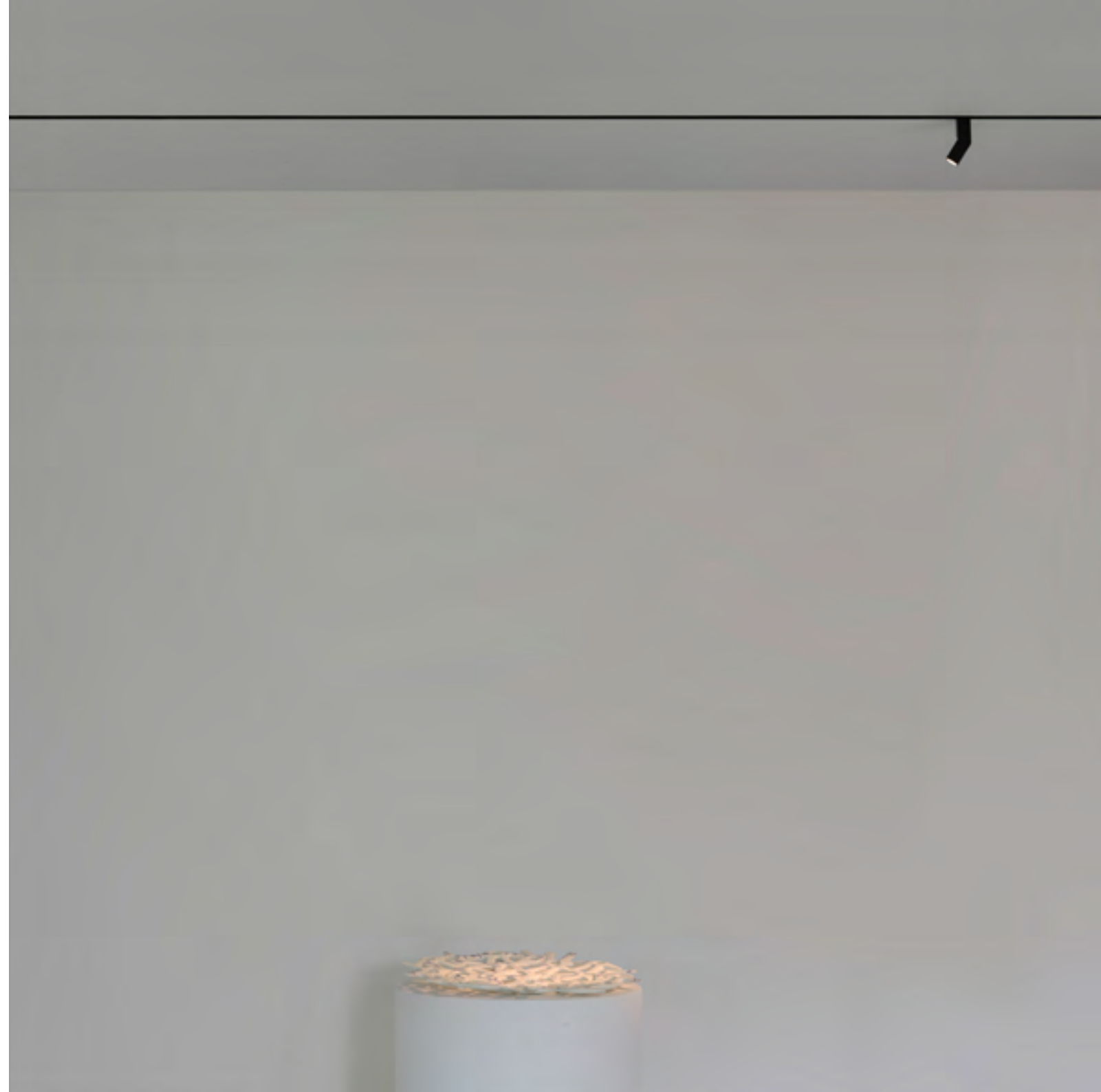



°turn





°plasterkit





°90° round corner











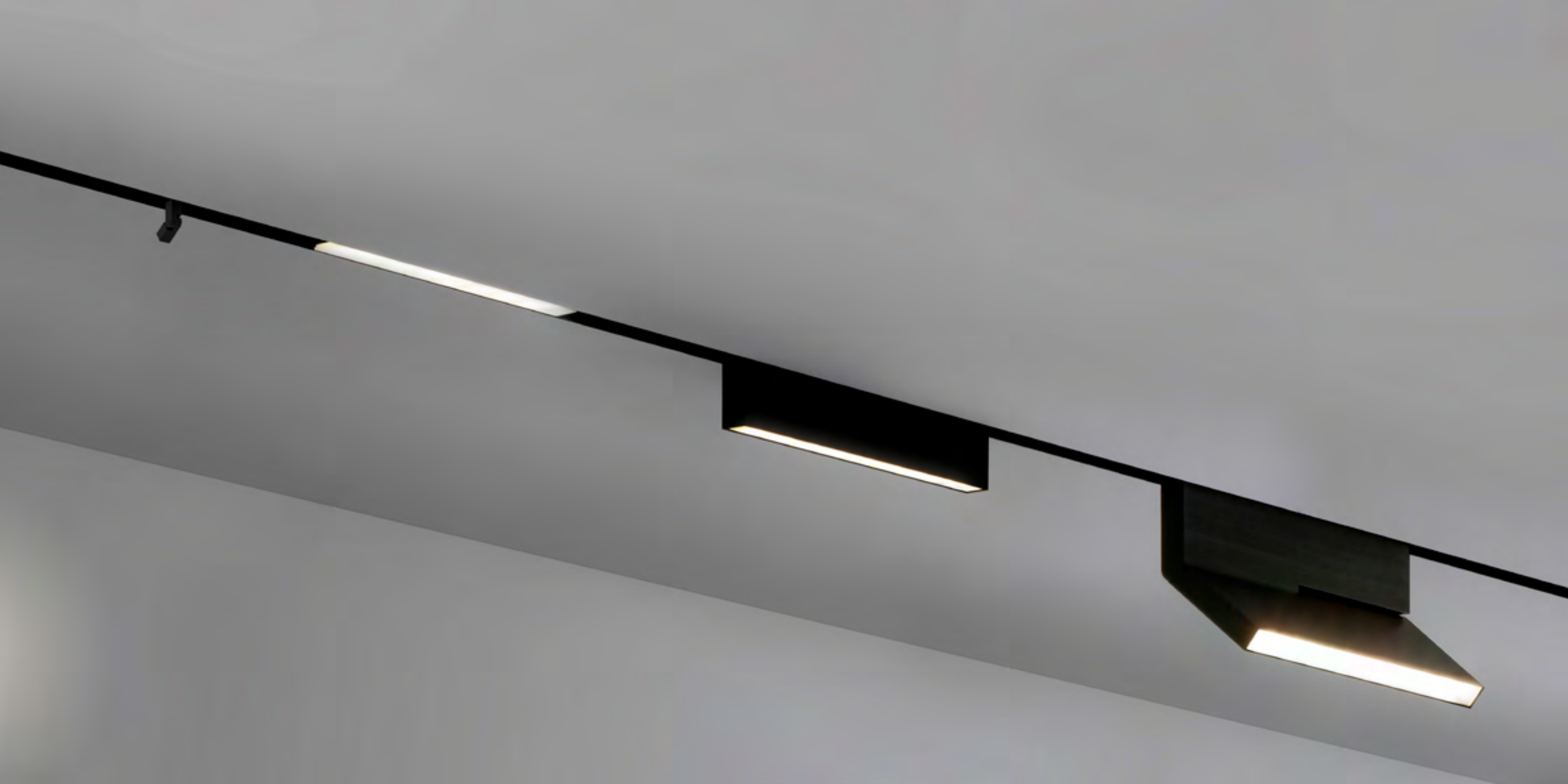

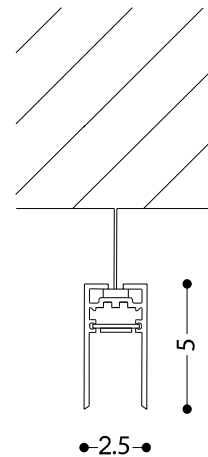
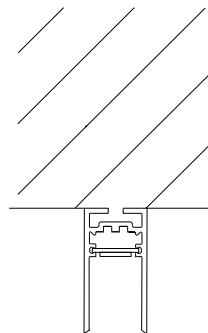
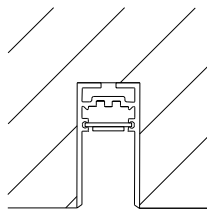

°line

colours



L.4000.**C.T**

track lenght 4000 mm

Accessoires

C - body colour
T - mount type

BK= Black, **WH**= White, **AL**= Aluminium
BI= Built in, **SM**= Surface mounted, **PD**= Pendant*

L.EC.BK End Cap Black
L.EC.WH End Cap White
L.EC.AL End Cap Aluminium
L.BI.MB Track Built In Mounting Bracket
L.MC.ST Track Mechanical Connector straight
L.MC.90° Track Mechanical Connector plate 90°
L.CORN.RND 90° Round Corner
PD.EC.8M Pendant Extension Cable 8 m

L.L.**C.T**

track custom length

L - lenght
C - body colour
T - mount type

300...4000 mm
BK= Black, **WH**= White, **AL**= Aluminium
BI= Built in, **SM**= Surface mounted, **PD**= Pendant*

material: painted aluminium - weight: 7,1 kg - 24VDC - max 400W - 2 circuit track - *standard cable of 2 m



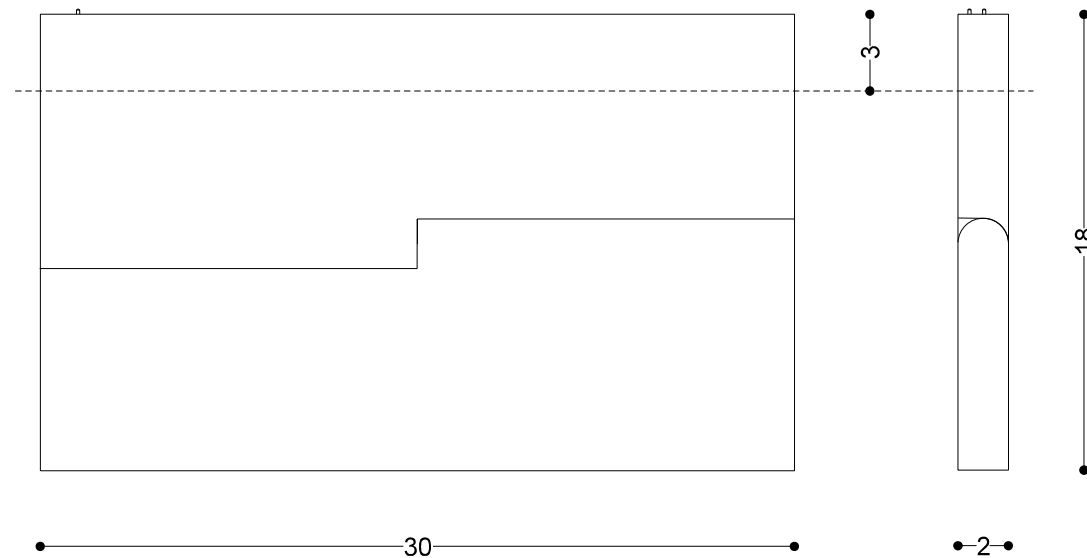

°knick

colours

KNICK.**L.C.D.V**

KNICK Fixture - 16x cree LED

L - LED colour **WW**= Warm White 2700K, **WW2**= Warm White 3000K cri 90, **NW**= Neutral White 3500K
C - body colour **BK**= Black, **WH**= White, **AL**= Aluminium
D - diffuser **F**= Frosted Ice
V - version **T**= Track mount, **BI**= Built In (Monopoint version *plasterkit required)

Accessoires

*PL.300 Plasterkit 300 mm *only for BI (monopoint) version, if no track required

material: painted aluminium - weight: 1 kg - 24VDC - max 30W

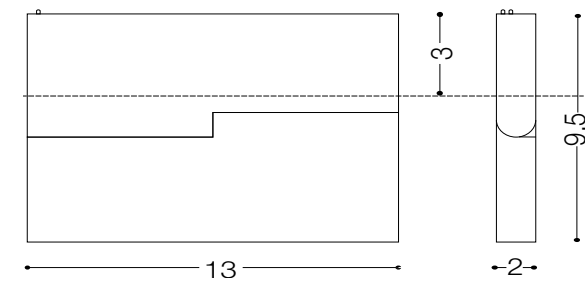

°knick small

colours

KNICK.S.**L.C.B.V**

KNICK SMALL Fixture - 12x cree LED

L - LED colour **WW**= Warm White 2700K, **WW2**= Warm White 3000K cri 90, **NW**= Neutral White 3500K
C - body colour **BK**= Black, **WH**= White, **AL**= Aluminium
B - beam angle **25, 40** degrees
V - version **T**= Track mount, **BI**= Built In (Monopoint version *plasterkit required)

Accessoires

*PL.130 Plasterkit 130 mm *only for BI (monopoint) version, if no track required
OP.KNICK.S.FI Frosted Ice diffuser

material: painted aluminium - weight: 350 g - 24VDC - max 15W



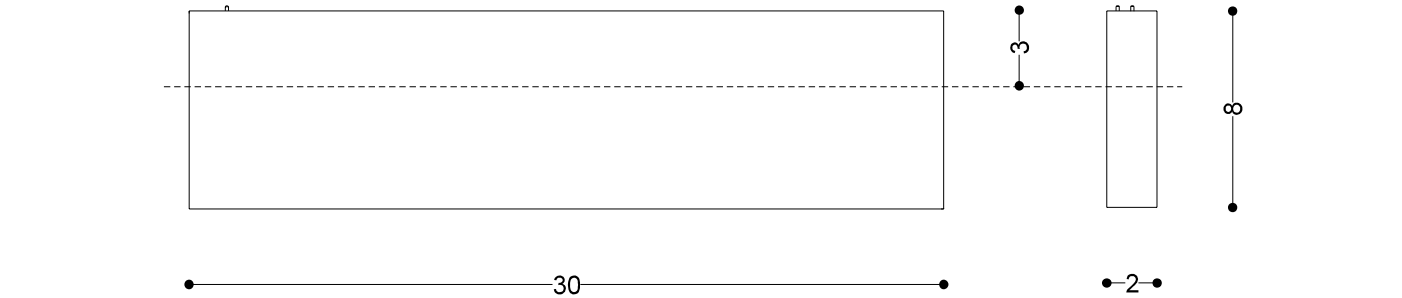

°out colours

OUT.**L.C.D.V** OUT Fixture - 16x cree LED

L - LED colour **WW**= Warm White 2700K, **WW2**= Warm White 3000K cri 90, **NW**= Neutral White 3500K
C - body colour **BK**= Black, **WH**= White, **AL**= Aluminium
D - diffuser **F**= Frosted Ice
V - version **T**= Track mount, **BI**= Built In (Monopoint version *plasterkit required)

Accessoires

*PL.300 Plasterkit 300 mm *only for BI (monopoint) version, if no track required

material: painted aluminium - weight: 450 g - 24VDC - max 30W

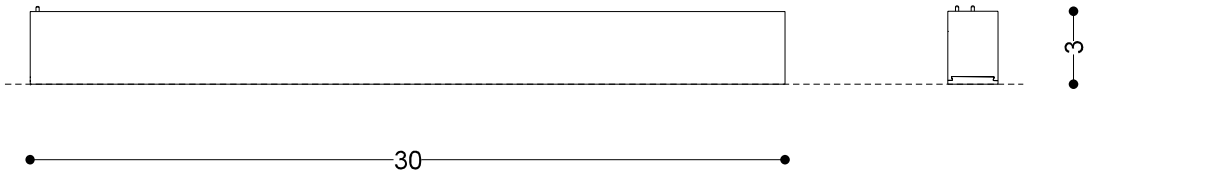

°in colours

IN.**L.C.D.V** IN Fixture - 16x cree LED

L - LED colour **WW**= Warm White 2700K, **WW2**= Warm White 3000K cri 90, **NW**= Neutral White 3500K
C - body colour **BK**= Black, **WH**= White, **AL**= Aluminium
D - diffuser **F**= Frosted Ice
V - version **T**= Track mount, **BI**= Built In (Monopoint version *plasterkit required)

Accessoires

*PL.300 Plasterkit 300 mm *only for BI (monopoint) version, if no track required

material: painted aluminium - weight: 260 g - 24VDC - max 20W



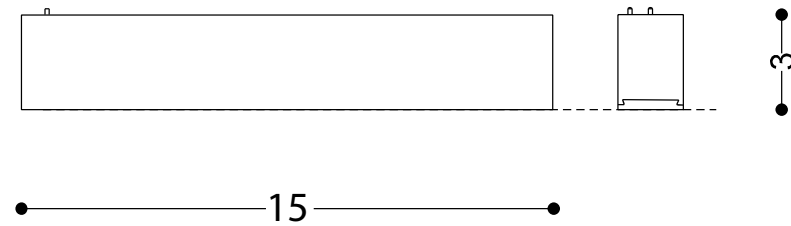

°in small

colours

IN.S. L.C.D.V	IN SMALL Fixture - 8x cree LED
L - LED colour	WW = Warm White 2700K, NW = Neutral White 3500K
C - body colour	BK = Black, WH = White, AL = Aluminium
D - diffuser	F = Frosted Ice
V - version	T = Track mount, BI = Built In (Monopoint version *plasterkit required)

Accessoires

*PL.150	Plasterkit 150 mm *only for BI (monopoint) version, if no track required
---------	--

material: painted aluminium - weight: 140 g - 24VDC - max 10W

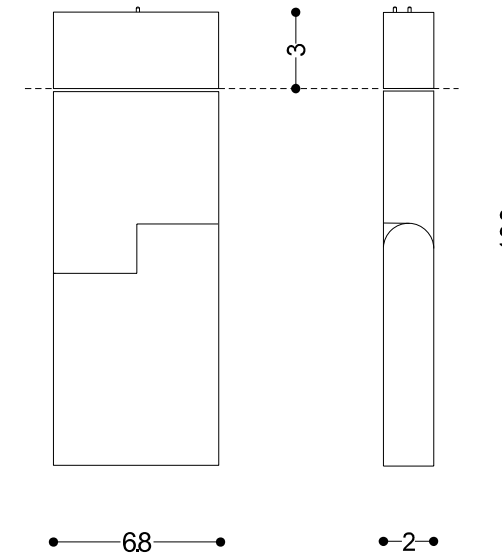

°turn

colours

TURN. L.C.B.V	TURN Fixture - 6x cree LED
L - LED colour	WW = Warm White 2700K, WW2 = Warm White 3000K cri 90, NW = Neutral White 3500K
C - body colour	BK = Black, WH = White, AL = Aluminium
B - beam angle	25, 30, 40 degrees
V - version	T = Track mount, BI = Built In (Monopoint version *plasterkit required)

Accessoires

*PL.70	Plasterkit 70 mm *only for BI (monopoint) version, if no track required
OP.TURN.25	extra optics 25°
OP.TURN.30	extra optics 30°
OP.TURN.40	extra optics 40°
OP.TURN.FI	Frosted Ice diffuser

material: painted aluminium - weight: 380 g - 24VDC - max 10W



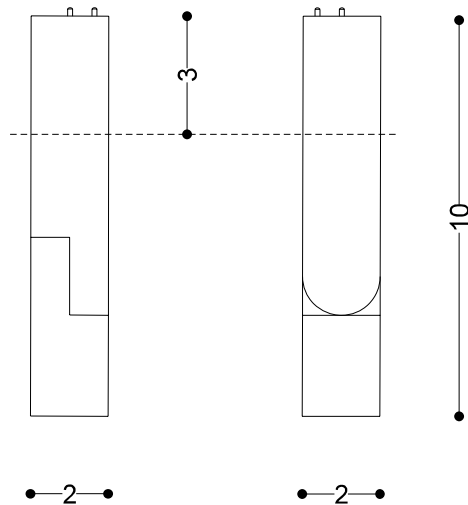
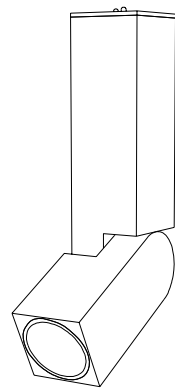

°dot

colours

DOT. L.C.D.V	DOT Fixture - Cree LED 8°
L - LED colour	WW = Warm White 2700K, WW2 = Warm White 3000K, NW = Neutral White 3500K, CW = Cold White +6000K, R = Red, B = Blue, G = Green
C - body colour	BK = Black, WH = White, AL = Aluminium
V - version	T = Track mount, BI = Built In (Monopoint version *plasterkit required)

Accessoires

*PL.DOT	Plasterkit Dot *only for BI (monopoint) version, if no track required
---------	---

material: painted aluminium - weight: 80 g - 24VDC - max 3W

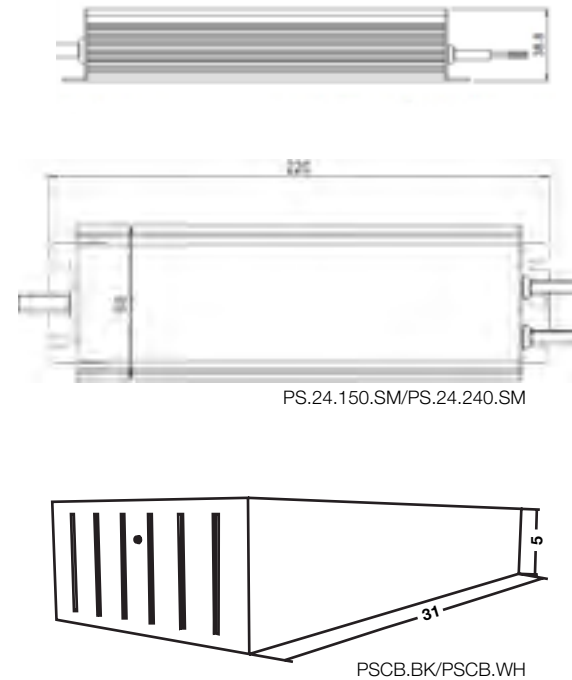

°power supplies surface mount

PS.24.60.SM	Power supply 24V DC 60W - surface mount
PS.24.150.SM	Power supply 24V DC 150W - surface mount
PS.24.240.SM	Power supply 24V DC 240W - surface mount
PSCB.BK	Power Supply Ceiling Box - colour black
PSCB.WH	Power Supply Ceiling Box - colour white

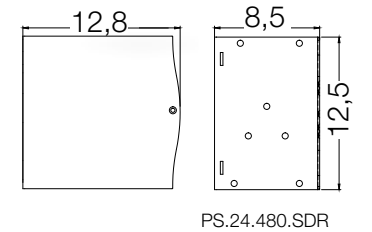
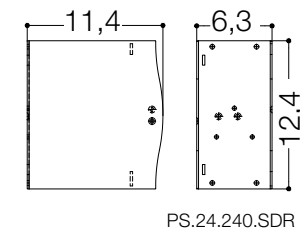
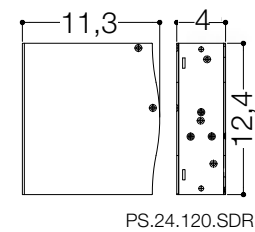
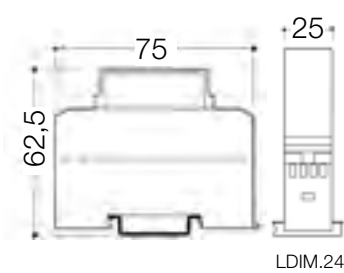
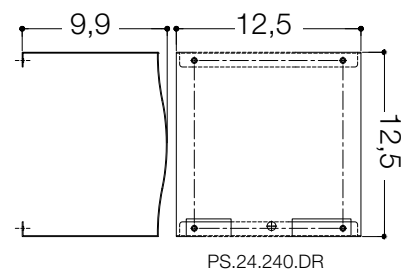
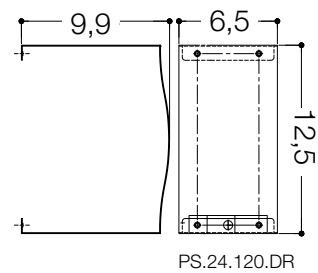

°power supplies DIN Rail mount

°dim module

PS.24.120.DR Power supply 24V DC 120W - DIN Rail mount
PS.24.240.DR Power supply 24V DC 240W - DIN Rail mount

LDIM.24V Dimmodule 24V DC max. 240W, control by
0/1-10V or potentiometer - DIN Rail mount

°power supplies DIN Rail mount small

PS.24.120.SDR Power supply 24V DC 120W Small form - DIN Rail mount
PS.24.240.SDR Power supply 24V DC 240W Small form - DIN Rail mount
PS.24.480.SDR Power supply 24V DC 480W Small form - DIN Rail mount

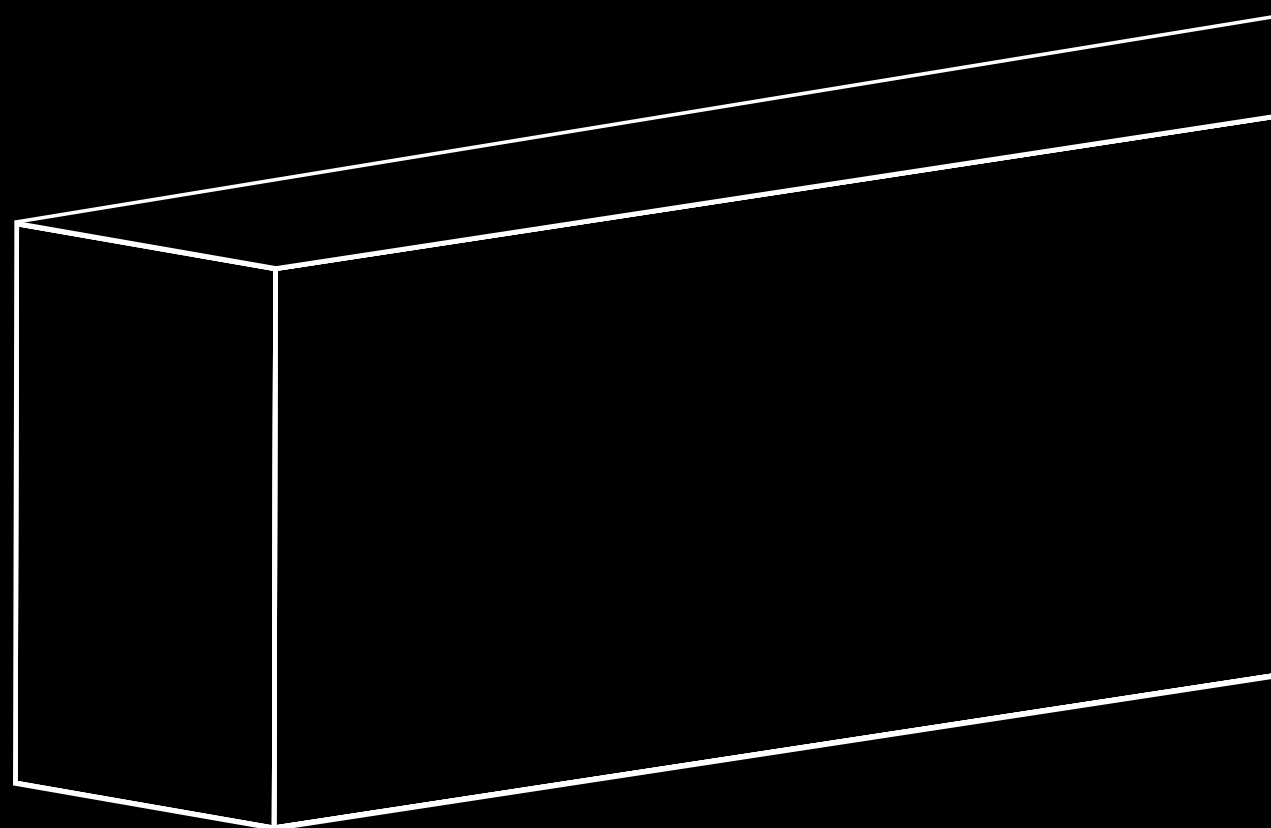

°led line



Continues lines of light,
without limits.
Each led module can be
cut every 8 cm, this gives
architects and lighting
designers a lot of flexibility.
Led line has a very good
efficiency. A high tech
diffusor was implemented
to block as less light as
possible and still give an
opal look. Led line can be
installed surface mounted,
recessed and pendant.
It offers a lot of control
possibilities: DALI, 1-10V
and DMX. Available in
anodized aluminum, black
or white.



°led line 60





°led line 25

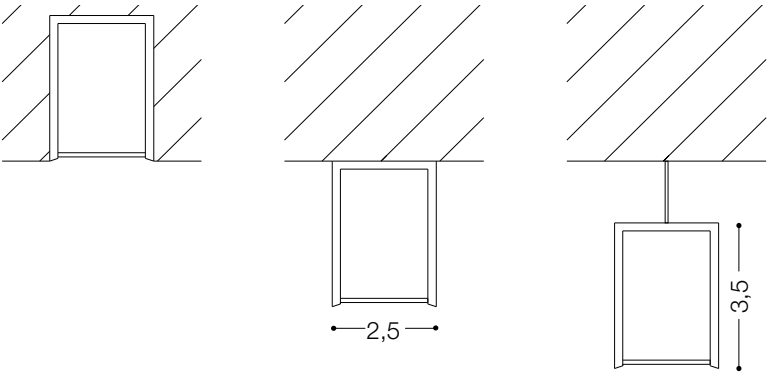

°led line 25

colours

LL25.2000.**C.T.K** led line 25 - standard length 2000 mm - led modules cuttable every 8 cm

C - body colour
T - mount type
K - LED colour

BK= Black, **WH**= White, **AL**= Aluminium
BI= Built in (recessed), **SM**= Surface mounted, **PD**= Pendant
27= 2700K, **30**= 3000K, **RGB**= Red + Green + Blue

LL25.**L.C.T.K** led line 25 - custom length

L - length
C - body colour
T - mount type
K - LED colour

100...4000 mm
BK= Black, **WH**= White, **AL**= Aluminium
BI= Built in (recessed), **SM**= Surface mounted, **PD**= Pendant
27= 2700K, **30**= 3000K, **RGB**= Red + Green + Blue

Required accessoires

LL25.EC.BK
LL25.EC.WH
LL25.EC.AL
Power Supplies

led line 25 End Cap Black
led line 25 End Cap White
led line 25 End Cap Aluminium
See page 41 - 43

Optional accessoires

LDIM.24V
ed.analog.1-24e
ed.dali.1-24e
ed.dmx 1-24e
ed.booster.1-24e
ed.analog.3 -24e
ed.dali.3 -24e
ed.dmx 3 -24e
ed.booster.3 -24e

1Channel PWM Dimmer 24V max. 240W , control by 0/1-10V - DIN Rail mount
1Channel PWM Dimmer 24V max. 145W , control by 0/1-10V
1Channel PWM Dimmer 24V max. 145W , control by DALI
1Channel PWM Dimmer 24V max. 145W , control by DMX
1Channel PWM Dimmer 24V max. 145W , booster for ed.analog/dali/dmx. 1-24e
RGB PWM Dimmer 24V max , 145W , control by 1-10V
RGB PWM Dimmer 24V max. 145W , control by DALI
RGB PWM Dimmer 24V max. 145W , control for DMX
RGB PWM Dimmer 24V max. 145W , booster for ed.analog/dali/dmx. 3-24e

material: anodized / painted aluminium - weight: 0,8 kg/m - 24VDC - 13W/m



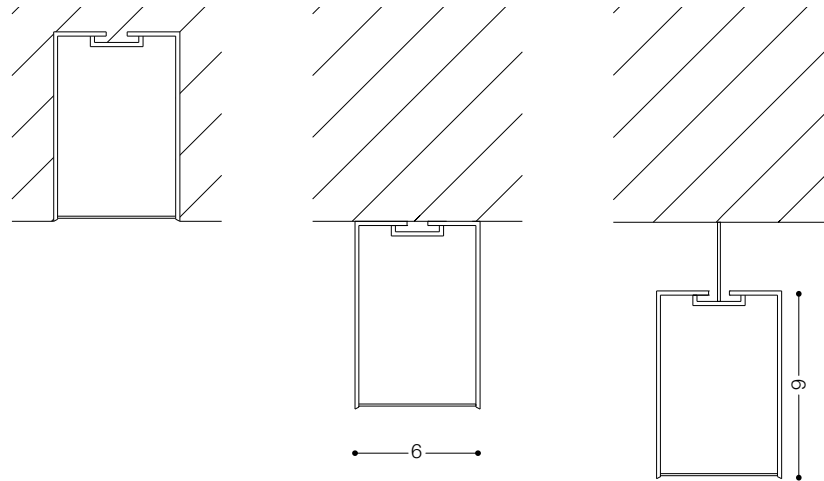

°led line 60

colours   

LL60.2000.**C.T.K** led line 60 - standard length 2000 mm - led modules cuttable every 8 cm

C - body colour **BK**= Black, **WH**= White, **AL**= Aluminium
T - mount type **BI**= Built in (recessed), **SM**= Surface mounted, **PD**= Pendant
K - LED colour **27**= 2700K, **30**= 3000K

LL60.**L.C.T.K** led line 60 - custom length

L - length 100...4000 mm
C - body colour **BK**= Black, **WH**= White, **AL**= Aluminium
T - mount type **BI**= Built in (recessed), **SM**= Surface mounted, **PD**= Pendant
K - LED colour **27**= 2700K, **30**= 3000K

Required accessoires

LL60.EC.BK Track End Cap Black
LL60.EC.WH Track End Cap White
LL60.EC.AL Track End Cap Aluminium

Optional accessoires

LL60.MB Mounting Bracket for recessed mounting
LL60.MC.ST Mechanical Connector plate Straight
LL60.MC.90° Mechanical Connector plate 90°
LL60.CORN.RND.BK.27 Corner Round Black 2700K
LL60.CORN.RND.BK.30 Corner Round Black 3000K
LL60.CORN.RND.WH.27 Corner Round White 2700K
LL60.CORN.RND.WH.30 Corner Round White 3000K

material: anodized / painted aluminium - weight: 2,5 kg/m - 230VAC - 26W/m - Not dimmable

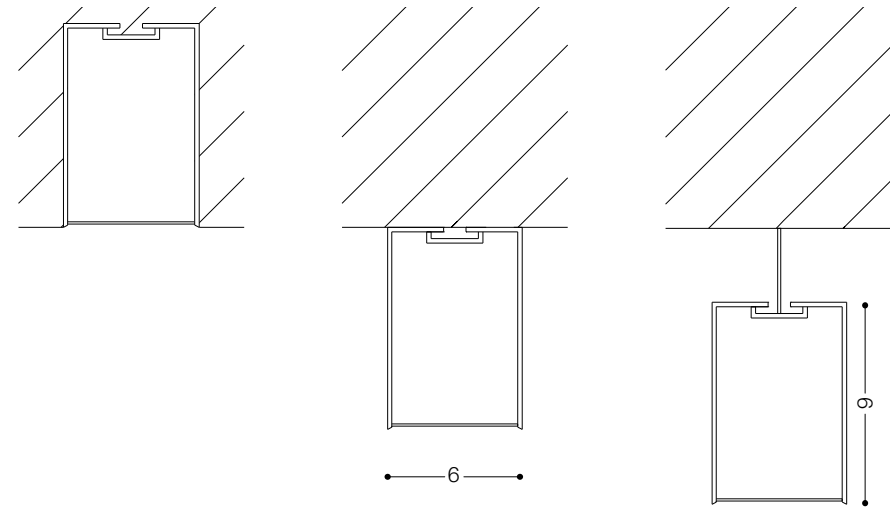

°led line 60 - Dimmable

colours   

LL60.2000.**C.T.K** led line 60 - standard length 2000 mm - led modules cuttable every 8 cm

C - body colour **BK**= Black, **WH**= White, **AL**= Aluminium
T - mount type **BI**= Built in (recessed), **SM**= Surface mounted, **PD**= Pendant
K - LED colour **27**= 2700K, **30**= 3000K
D - dimming **DAL**= DALI, **DMX**= DMX, **10V**= 1-10V

LL60.**L.C.T.K.D** led line 60 - custom length

L - length 100...4000 mm
C - body colour **BK**= Black, **WH**= White, **AL**= Aluminium
T - mount type **BI**= Built in (recessed), **SM**= Surface mounted, **PD**= Pendant
K - LED colour **27**= 2700K, **30**= 3000K
D - dimming **DAL**= DALI, **DMX**= DMX, **10V**= 1-10V

Required accessoires

LL60.EC.BK Track End Cap Black
LL60.EC.WH Track End Cap White
LL60.EC.AL Track End Cap Aluminium

Optional accessoires

LL60.MB Mounting Bracket for recessed mounting
LL60.MC.ST Mechanical Connector Straight
LL60.MC.90° Mechanical Connector plate 90°
LL60.CORN.RND.BK.27 Corner Round Black 2700K
LL60.CORN.RND.BK.30 Corner Round Black 3000K
LL60.CORN.RND.WH.27 Corner Round White 2700K
LL60.CORN.RND.WH.30 Corner Round White 3000K

material: anodized / painted aluminium - weight: 2,5 kg/m - 230VAC - 26W/m



Curled as a curly moustache, is the corpus of the light element, called "Poirot", with whom this moustache is associated the best. Available as hanging lamp or two types of wall lamp and in several colors. With a lumen output of over 2500lm for the wall version and over 7000lm for the hanging version, the Poirot is perfect for situations where a lot of light is required.

design by Bart Lens.







°poirot



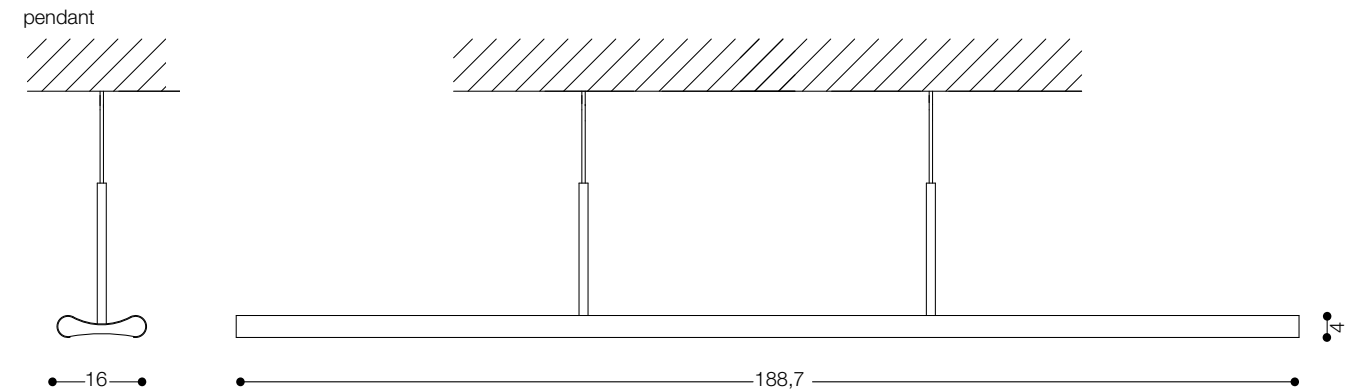
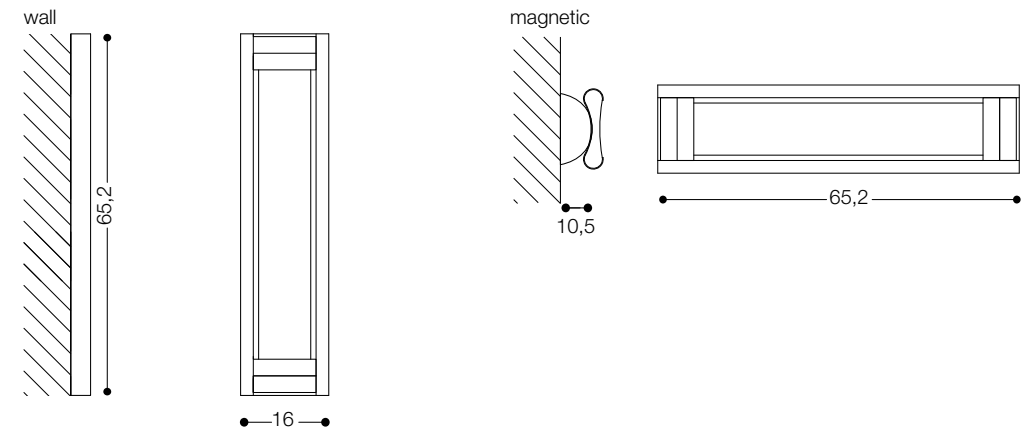
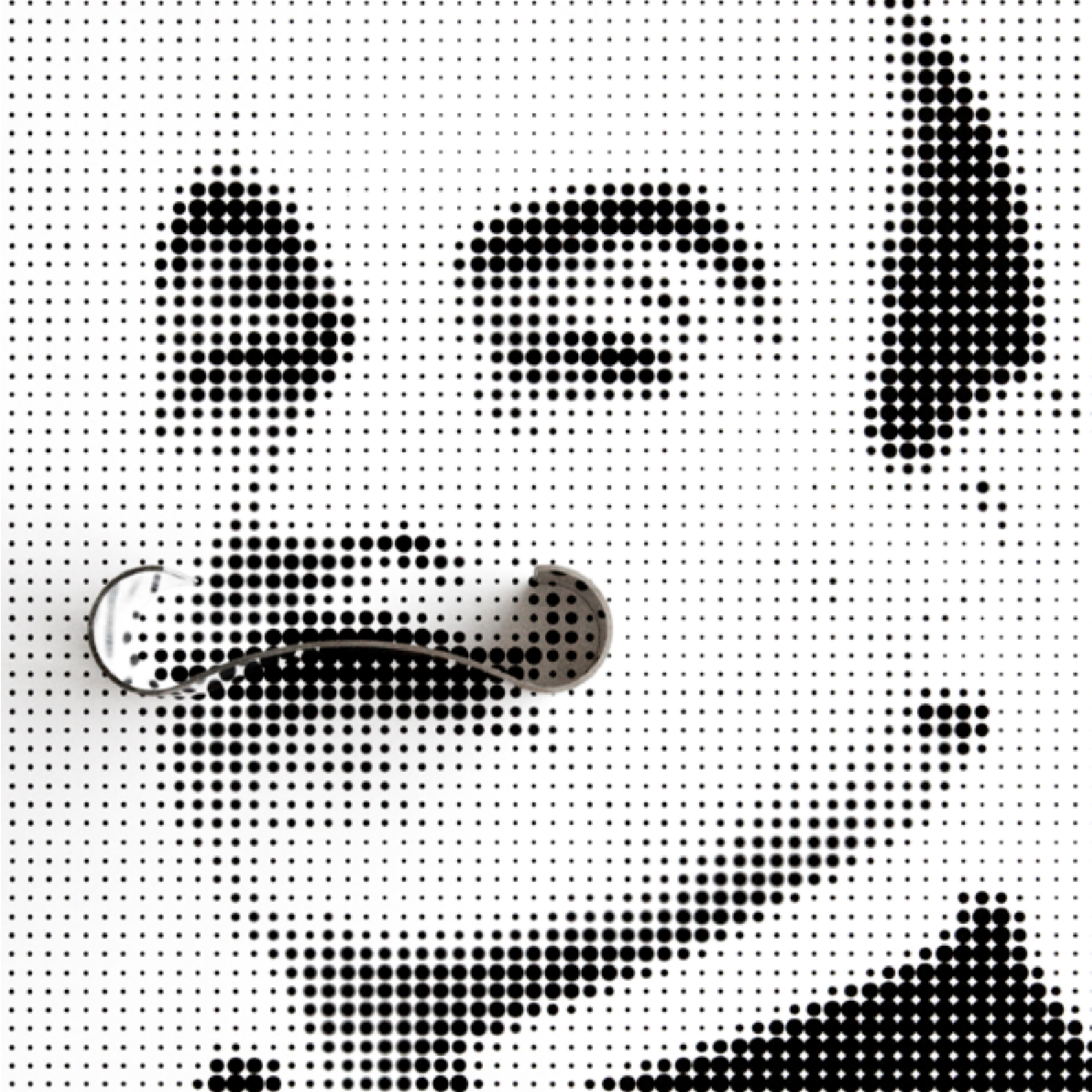

°poirot

colours

- | | |
|---------------|--|
| PRT.WH.30 | POIROT White |
| PRT.BRZ.30 | POIROT Bronze |
| PRT.RAL.30 | POIROT Other RAL colours |
| PRT.MG.WH.30 | POIROT Magnetic version - White - incl. wall bracket |
| PRT.MG.BRZ.30 | POIROT Magnetic version - Bronze - incl. wall bracket |
| PRT.MG.RAL.30 | POIROT Magnetic version - Other RAL colours - incl. wall bracket |
| PRT.PD.WH.30 | POIROT Pendant version - White |
| PRT.PD.BRZ.30 | POIROT Pendant version - Bronze |
| PRT.PD.RAL.30 | POIROT Pendant version - Other RAL colours |

Accessoires

PRT.P LX	POIROT - Diffuser
----------	-------------------

material: painted aluminium - weight: 1,4 kg / pendant: 4,3 kg - 230VAC - 34W / pendant: 102W - 3000K LED



Two hemispheres, a couple or twins, of which one of them is lighted by LED and rotates 190° / 360° on its axis. Single or in line, it evokes images of a solar eclipse, a chesterfield chair or a diabolo toy. Available as table-lamp, wall lamp or ceiling lamp and in several colors.

design by Bart Lens.

DESIGN PLUS
powered by: **light+building**





°diabolo



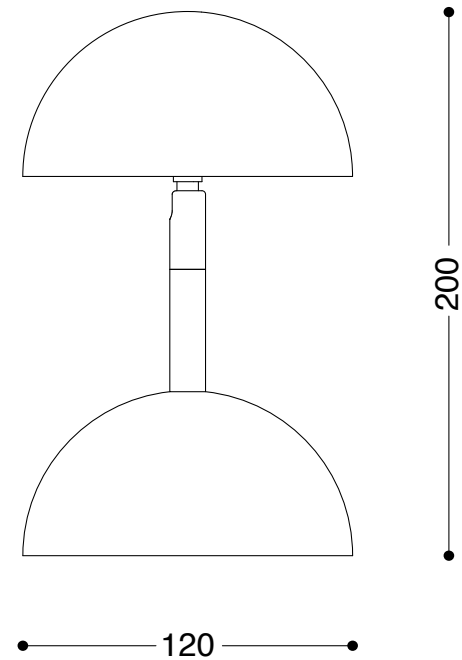

°diabolo

colours

DBL.WH.30	DIABOLO White - 3000K LED
DBL.BK.30	DIABOLO Black - 3000K LED
DBL.BRZ.30	DIABOLO Bronze - 3000K LED
DBL.BRS.30	DIABOLO Brass - 3000K LED
DBL.RAL.30	DIABOLO Other RAL colours - 3000K LED
DBL.TBL.WH.30	DIABOLO - Table model - White - 3000K LED
DBL.TBL.BK.30	DIABOLO - Table model - Black - 3000K LED
DBL.TBL.BRZ.30	DIABOLO - Table model - Bronze - 3000K LED
DBL.TBL.BRS.30	DIABOLO - Table model - Brass - 3000K LED
DBL.TBL.RAL.30	DIABOLO - Table model - Other RAL colours - 3000K LED
DBL.WH.27	DIABOLO - White - 2700K LED
DBL.BK.27	DIABOLO - Black - 2700K LED
DBL.BRZ.27	DIABOLO - Bronze - 2700K LED
DBL.BRS.27	DIABOLO - Brass - 2700K LED
DBL.RAL.27	DIABOLO - Other RAL colours - 2700K LED
DBL.TBL.WH.27	DIABOLO - Table model - White - 2700K LED
DBL.TBL.BK.27	DIABOLO - Table model - Black - 2700K LED
DBL.TBL.BRZ.27	DIABOLO - Table model - Bronze - 2700K LED
DBL.TBL.BRS.27	DIABOLO - Table model - Brass - 2700K LED
DBL.TBL.RAL.27	DIABOLO - Table model - Other RAL colours - 2700K LED

Required accessoires for DBL.TBL

DBL.TBL.CBL.WH	2m textile cable white
DBL.TBL.CBL.BK	2m textile cable black
DBL.TBL.CBL.BW	2m textile cable black + white
DBL.TBL.CBL.GD	2m textile cable gold

DBL.____.RGB DIABOLO - RGB version 24VDC DMX *all models above available with RGB led*

material: painted aluminium - weight: 1,2 kg - 230VAC - 5W - dimmable 1-10V



Inspired by the growing nose of the wooden puppet that was brought alive, designer Bart Lens invented a light line which grows or dims in length. A wooden fixture which is realized by a real carpenter, the story of Pinocchio. Pinocchio can be used as a floor lamp, wall lamp or hanging lamp.

design by Bart Lens.









°pinocchio leaf wood

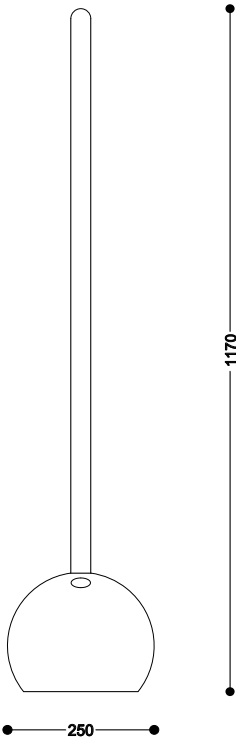

°Pinocchio

colours

PINO.WD	PINOCCHIO - Wood
PINO.WH	PINOCCHIO - White
PINO.CH	PINOCCHIO - Chrome
PINO.GO	PINOCCHIO - Gold
PINO.FL.WD	PINOCCHIO Floor Model - Wood
PINO.FL.WH	PINOCCHIO Floor Model - White
PINO.FL.CH	PINOCCHIO Floor Model - Chrome
PINO.FL.GO	PINOCCHIO Floor Model - Gold

Accessoires

PINO.LEAF.WD	PINOCCHIO Leaf Wood
PINO.LEAF.WH	PINOCCHIO Leaf White

material: glass + American walnut wood /metal - weight: 5 kg - 230VAC - 20W - 2700K LED - dimmable 0/1-10V



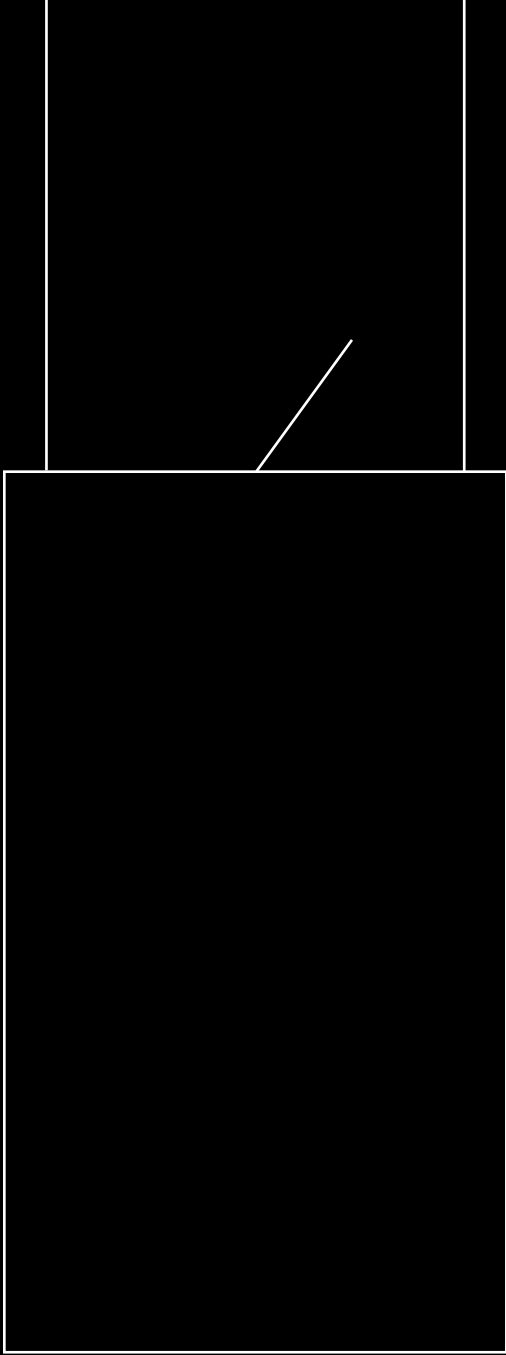

°led on fire

In a T-restaurant in Peking (China), Mr. Lens was eating at an immense mirror table with candles hanging above him. It was cozy, romantic, but also streamlined and modern. For another design we already experimented with hanging led-lights suspended from low charged wires.

We marveled at the vision of a completely accidental, out-of-the box combination of a led underneath a burning candle. The effect of the translucent candle-emulsion was also heartwarming. The apparition of a led fixture, burning, not at all kitschy, with light shimmering through the material structure is imprinted on our minds. "The led is on fire", we tried it out.

design by Bart Lens.





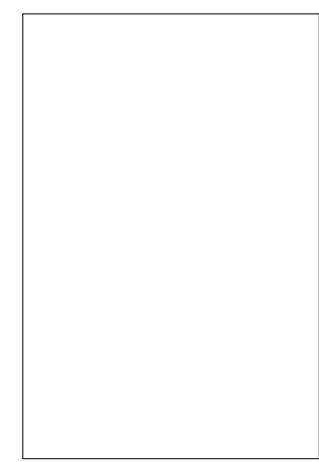

10

15

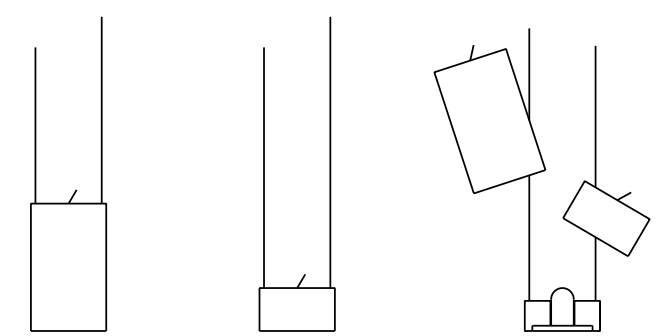

candle burns

replacing candle

°led on fire

LOF led on fire

Accessoires

- LOF.ROS.R Ceiling rose Recessed
- LOF.ROS.T Ceiling rose Trimless
- LOF.ROS.S Ceiling rose Surface mount
- LOF.RC Replacement waxcandle

materials: aluminium, glass, wax candle - weight: 1,2 kg - indoor use - 230VAC - max 4W
included: 2m cables and LED driver 1-10V dimmable



i-light is a thin, hanging tubular light fixture with an incorporated LED-light. The small loose-hanging chrome-plated sphere creates an unusual light and shadow play. The lamp can be used as trim lights, hanging lights, or – when several are combined – as a chandelier. When the tubes are hung low, the reflection of the chrome-plated rods produces a ‘starry sky effect’.

design by Bart Lens.





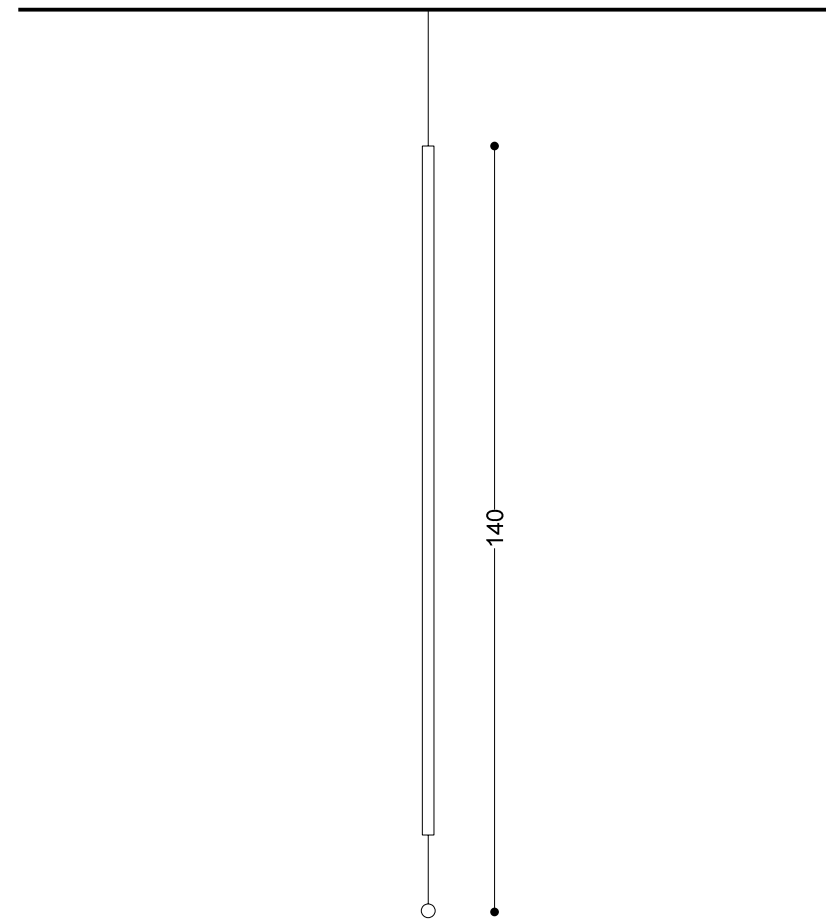

°i-light

IL i-light

material: chrome brass - weight: 1,4 kg - included: 2 m cable & rosas - 24VDC - max 2W
excl. power supply



de light ful is a hanging tubular light fixture with integrated LED light. With a light source on top and bottom, you can create your own atmosphere. The use of this lighting-object will give an extra dimension to your room. You can choose for a version with solid colors or for a version with dynamic colors controllable by DMX. The RGBW LEDs give you the opportunity to choose any desired color.







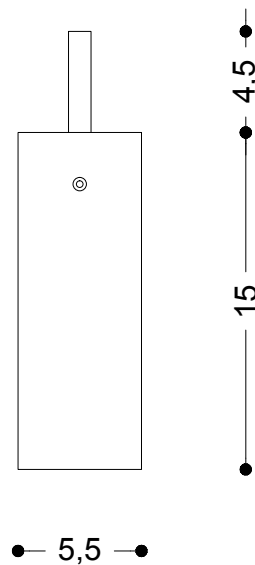

°de light ful colours

DLF55WHI. C.D.T.B	de light ful Fixture - 55 mm - Fixed Color (top: W, bottom: W)
C - body colour D - diffuser T - LED top B - LED bottom	BK = Black, WH = White F = Frosted Ice OR optics 10, 20, 30, 40 degrees WW = Warm White 3000K WW = Warm White 3000K
DLF55CLR. C.D.T.B	de light ful Fixture - 55 mm - Fixed Color (top: R/G/B/W/..., bottom: W)
C - body colour D - diffuser T - LED top B - LED bottom	BK = Black, WH = White F = Frosted Ice OR optics 10, 20, 30, 40 degrees R = Red, G = Green, B = Blue, W = White, Y =Yellow, M = Magenta, C = Cyan WW = Warm White 3000K
DLF55DMX5. C.D.T.B	de light ful Fixture - 55 mm - 5 channel DMX (top: RGBW, bottom: W)
C - body colour D - diffuser T - LED top B - LED bottom	BK = Black, WH = White F = Frosted Ice OR optics 10, 20, 30, 40 degrees RGBW = Red + Green + Blue + White WW = Warm White 3000K
Accessoires PS.24.16 PS.24.XXX DLF.ADR.XXX	Power supply 24DVC 16W for powering one fixture Power supply 24DVC ...W for powering several fixtures *see page 41-43 Pre-programmed DMX address

material: painted aluminium - weight: 350 g - 24VDC - max 15W

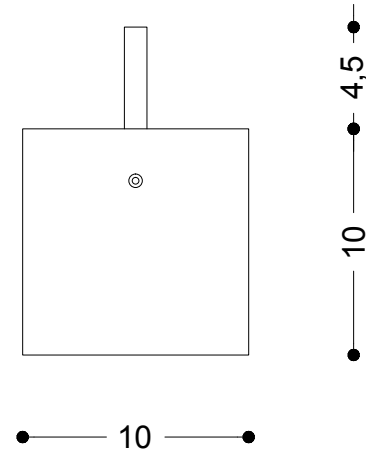

°de light ful colours

DLF100WHI. C.D.T.B	de light ful Fixture - 100 mm - Fixed Color (top: W , bottom: W)
C - body colour D - diffuser T - LED top B - LED bottom	BK = Black, WH = White F = Frosted Ice WW = Warm White 3000K WW = Warm White 3000K
DLF100CLR. C.D.T.B	de light ful Fixture - 100 mm - Fixed Color (top: R/G/B/W/... , bottom: W)
C - body colour D - diffuser T - LED top B - LED bottom	BK = Black, WH = White F = Frosted Ice R = Red, G = Green, B = Blue, W = White, Y = Yellow, M = Magenta, C = Cyan WW = Warm White 3000K
DLF100DMX5. C.D.T.B	de light ful Fixture - 100 mm - 5 channel DMX (top: RGBW , bottom: W)
C - body colour D - diffuser T - LED top B - LED bottom	BK = Black, WH = White F = Frosted Ice RGBW = Red + Green + Blue + White WW = Warm White 3000K
Accessoires PS.24.16 PS.24.XXX DLF.ADR.XXX	Power supply 24DVC 16W for powering one fixture (WHI/CLR version) Power supply 24DVC ...W for powering several fixtures *see page 41-43 Pre-programmed DMX address

material: painted aluminium - weight: 450 g - 24VDC - max 18W for WHI/CLR, max 22W for DMX version



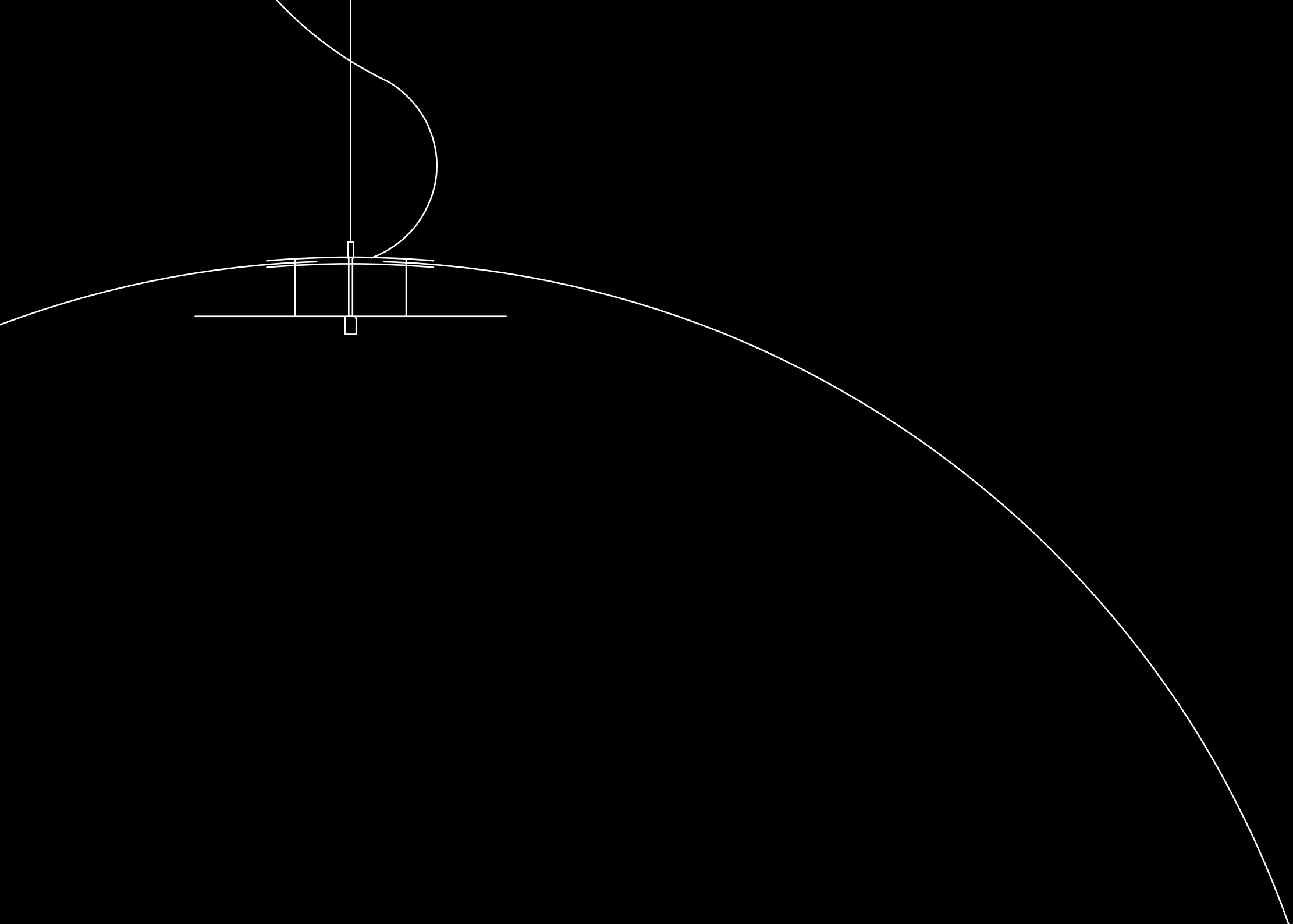

°sphere

Bart lens needed a large lamp that would create an encircling sphere of light above the conference table in their office, and so began the search. After a long and fruitless quest, he finally decided to design his own mega-light with the “sphere” of a dome.

The result has been likened to a “Calimero” dome, a giant bell, a half moon.... Everybody seems to have a different name for it.

design by Bart Lens.



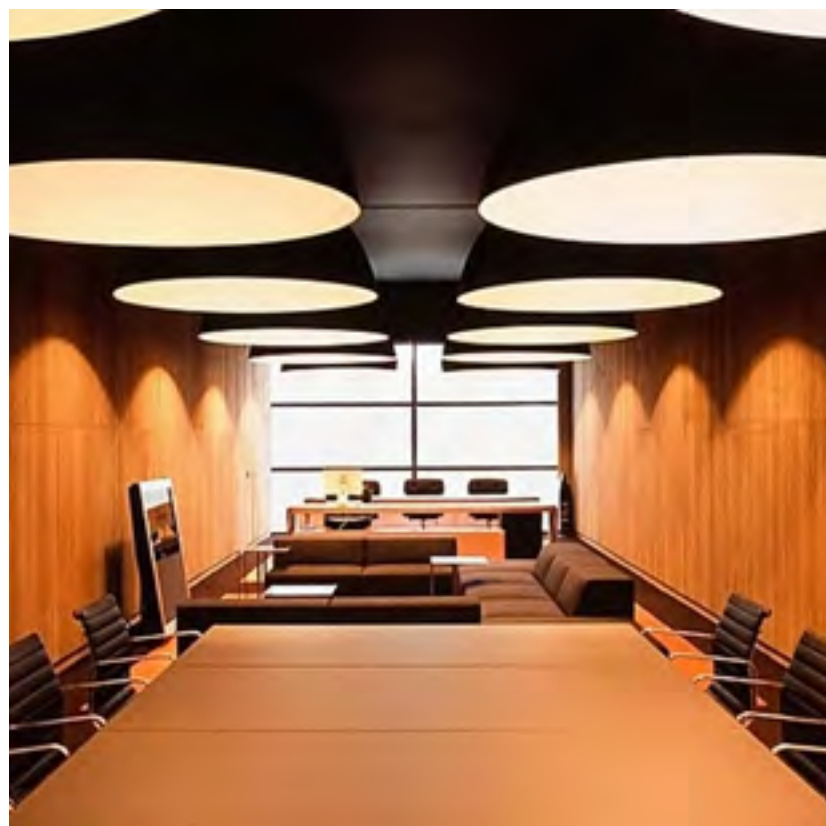







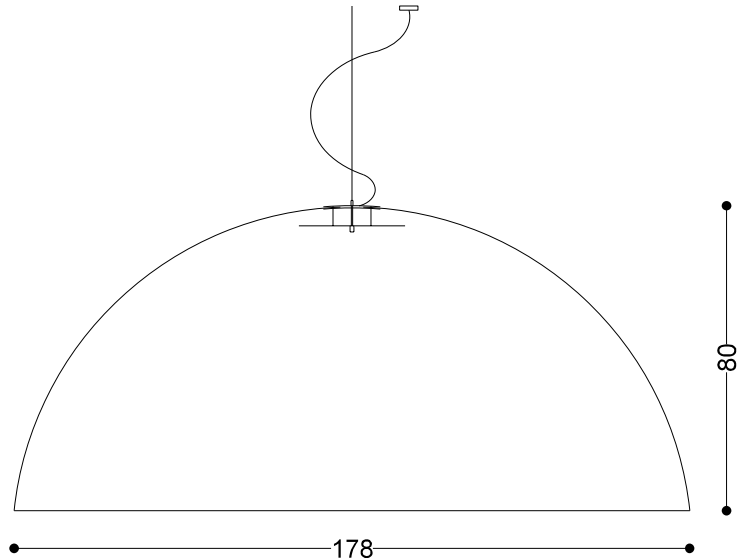

°sphere large 178

SPH.L.127.000	1 x E27 socket - excl lamp
SPH.L.227.000	2 x E27 socket - excl lamps
SPH.L.327.000	3 x E27 socket - excl lamps
SPH.L.427.000	4 x E27 socket - excl lamps
SPH.L.227.OPD	2 x E27 socket with pull dimmer - excl lamps
SPH.L.327.OPD	3 x E27 socket with pull dimmer - excl lamps
SPH.L.2200.000	TL circuline 22W
SPH.L.0040.000	TL circuline 40W
SPH.L.0055.000	TL circuline 55W
SPH.L.2240.000	TL circ 22W + 40W
SPH.L.2240.10V	TL circ 22W + 40W, dimmable 1-10V
SPH.L.2240.DAL	TL circ 22W + 40W, dimmable DALI
SPH.L.2255.000	TL circ 22W + 55W
SPH.L.2255.DAL	TL circ 22W + 55W, dimmable DALI
SPH.L.2200.127	TL circ 22W + 1 x E27 socket
SPH.L.0040.127	TL circ 40W + 1 x E27 socket
SPH.L.2240.127	TL circ 22W + 40W + 1 x E27 socket
SPH.L.1LED.3000	1 x LED module 3000lm cri90+, 37,5W, dimmable (1-10V) 2700K Warm white *3000K on request
SPH.L.3LED.3750	3 x LED module 3750lm cri90+, 46,5W, dimmable (phase cut) 2700K Warm white *3000K on request
SPH.L.3LED.9000	3 x LED module 9000lm cri90+, 112,5W, dimmable(1-10V) 2700K Warm white *3000K on request
PLX.SPH.50	coverplate diffuser plexi 50 cm Ø

material: ABS plastic, optional RAL colours / gold leaf both inside and out - weight: 25,5 kg
included : 2 m cable, rosas and suspension
230VAC - max 250W

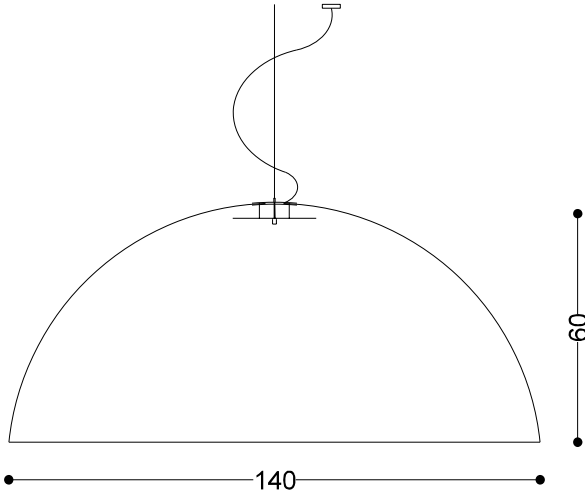

°sphere medium 140

SPH.M.127.000	SPH.S.127.000
SPH.M.227.000	SPH.S.227.000
SPH.M.327.000	SPH.S.327.000
SPH.M.427.000	SPH.S.427.000
SPH.M.227.OPD	SPH.S.227.OPD
SPH.M.327.OPD	SPH.S.327.OPD
SPH.M.2200.000	SPH.S.2200.000
SPH.M.0040.000	SPH.S.0040.000
SPH.M.0055.000	SPH.S.0055.000
SPH.M.2240.000	SPH.S.2240.000
SPH.M.2240.10V	SPH.S.2240.10V
SPH.M.2240.DAL	SPH.S.2240.DAL
SPH.M.2255.000	-
SPH.M.2255.DAL	-
SPH.M.2200.127	SPH.S.2200.127
SPH.M.0040.127	SPH.S.0040.127
SPH.M.2240.127	SPH.S.2240.127
SPH.M.1LED.1250	SPH.S.1LED.1250
SPH.M.1LED.3000	-
SPH.M.1LED.3750	-
SPH.M.3LED.9000	-

PLX.SPH.30
PLX.SPH.50

material: ABS plastic, optional RAL colours / gold leaf both inside and out - weight: M 13,5 kg / S 5 kg
included : 2 m cable, rosas and suspension - 230VAC - sphere medium max 150W, sphere small max 100W

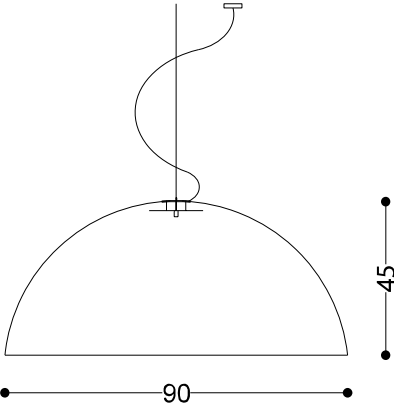

°sphere small 90

1 x E27 socket - excl lamp
2 x E27 socket - excl lamps
3 x E27 socket - excl lamps
4 x E27 socket - excl lamps
2 x E27 socket with pull dimmer - excl lamps
3 x E27 socket with pull dimmer - excl lamps
TL circuline 22W
TL circuline 40W
TL circuline 55W
TL circ 22W + 40W
TL circ 22W + 40W, dimmable 1-10V
TL circ 22W + 40W, dimmable DALI
TL circ 22W + 55W
TL circ 22W + 55W, dimmable DALI
TL circ 22W + 1 x E27 socket
TL circ 40W + 1 x E27 socket
TL circ 22W + 40W + 1 x E27 socket
1 x LED module 1250lm cri90+, 15,5W, dimmable (phase cut) 2700K Warm white *
1 x LED module 3000lm cri90+, 37,5W, dimmable (1-10V) 2700K Warm white *
3 x LED module 3750lm cri90+, 46,5W, dimmable(phase cut) 2700K Warm white *
3 x LED module 9000lm cri90+, 112,5W, dimmable(1-10V) 2700K Warm white *
*3000K on request

coverplate plexi 30 cm Ø
coverplate plexi 50 cm Ø

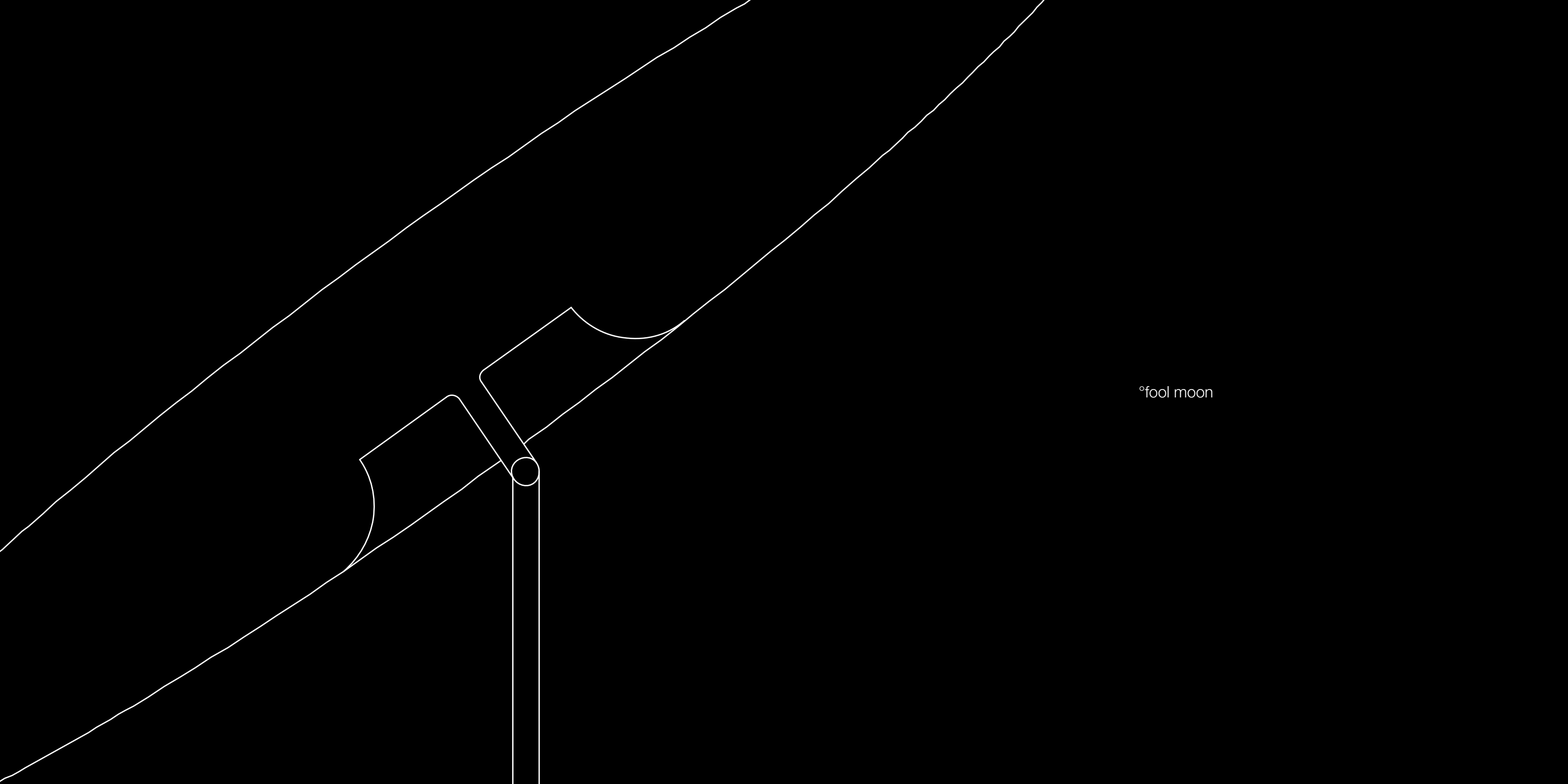

°fool moon

People have always been fascinated by the light of a perfect circle. The returning full moon and the natural phenomena ascribed to it (higher childbirth percentage, fertility, transformation from human to animal, etc.), the archetypical form of a UFO, the shape of a gong, the sun... are but a few striking examples.

Despite its shape of a full circle ('full moon'), the lamp can be used in several positions: horizontally, diagonally, obliquely or vertically ('fool moon'). Thanks to its large dimensions, the lamp is easily recognisable and has the possibility of demarcating or creating spaces. The lamp also has a highly symbolic value due to its imposed abstraction.

design by Bart Lens.





fool moon large







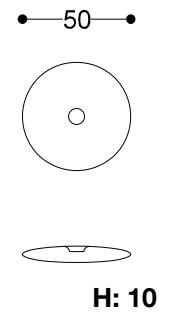
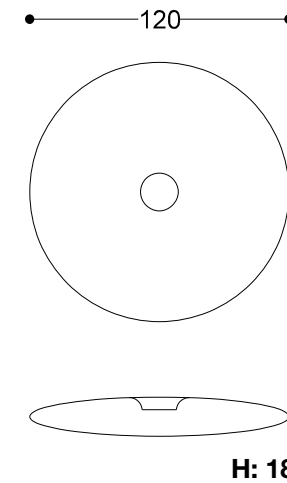
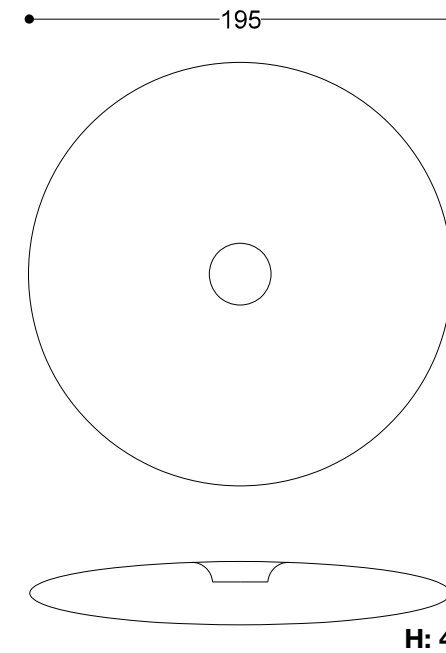

°fool moon large

FM.L.355.000	3 x PL 55W
FM.L.355.10V	3 x PL 55W dimmable 1-10V
FM.L.355.DAL	3 x PL 55W dimmable DALI
FM.L.355.RGB.DMX	3 x PL 55W + RGB LED DMX controllable
FM.L.355.RGB.DAL	3 x PL 55W + RGB LED DALI controllable
FM.L.355.RGB.M	3 x PL 55W + RGB LED master with remote control
FM.L.355.RGB.S	3 x PL 55W + RGB LED slave

°fool moon medium

FM.M.324.000	3 x PL24W
FM.M.324.10V	3 x PL24W dimmable 1-10V
FM.M.000.RGB.DMX	RGB LED DMX controllable
FM.M.000.RGB.DAL	RGB LED DALI controllable
FM.M.000.RGB.M	RGB LED master with remote
FM.M.000.RGB.S	RGB LED slave

°fool moon small

FM.S.308.000	3 x PL8W
FM.S.RGB.DMX	RGB LED DMX controllable
FM.S.RGB.DAL	RGB LED DALI controllable
FM.S.RGB.M	RGB LED Master with remote
FM.S.RGB.S	RGB LED Slave

material: PE - weight: L: 33 kg / M: 20 kg / S: 3 kg - included : 2 m cable, rosas and suspension elements
230VAC - FM large max 200W, FM medium max 72W, FM small max 42W



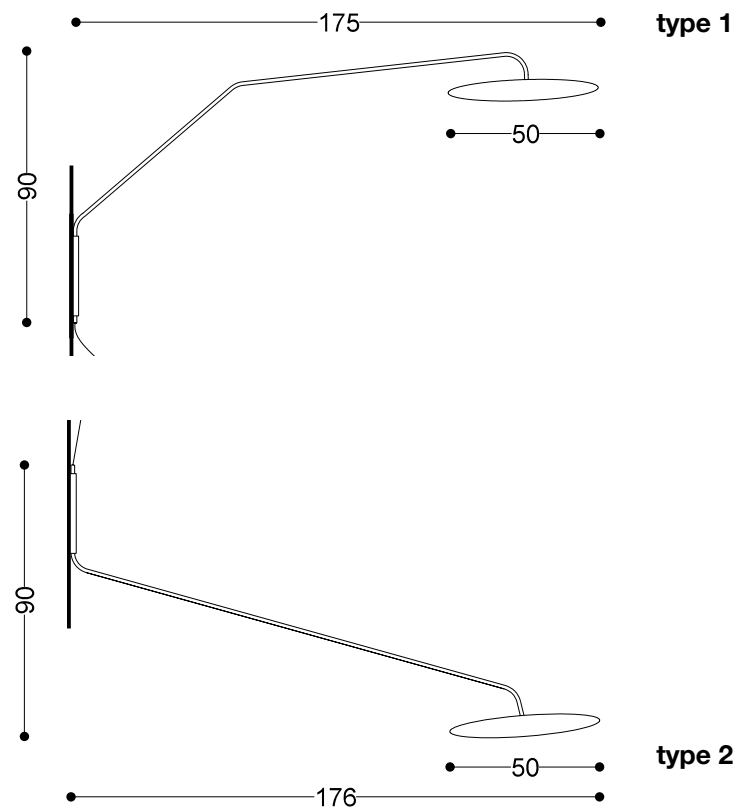

°fool moon wall type1		°fool moon wall type2	
FM.S.308.WALL1	3X PL 8W E14 socket	FM.S.308.WALL2	3X PL 8W E14 socket
materials: PE & steel - weight: 4,5 kg - 230VAC - max 42W			

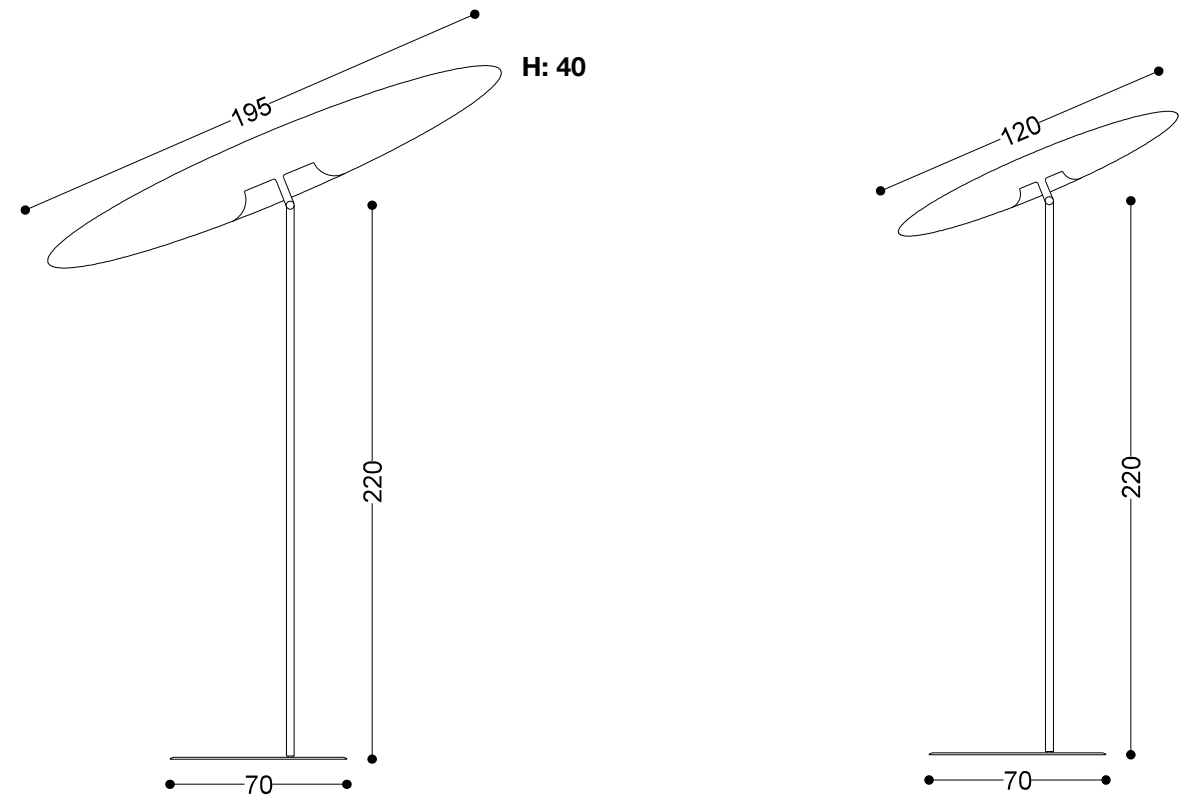

°fool moon floor large		°fool moon floor medium	
FM.L.355.FLR	3X PL 55W floor	FM.M.324.FLR	3X PL 24W floor
materials: PE & steel - weight: L: 52 kg / M: 38 kg - 230VAC - FM large max 200W, FM medium max 72W			



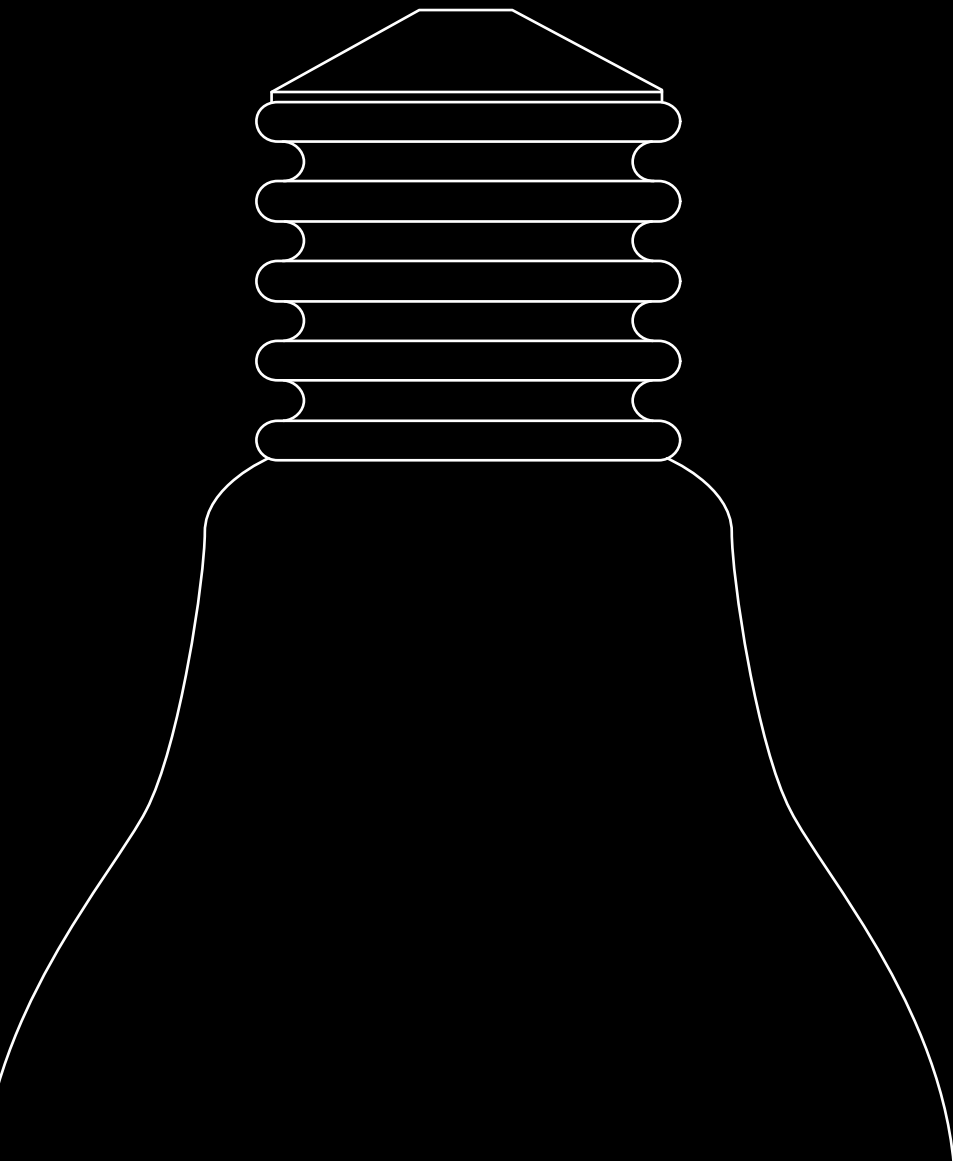

°SO1

The design of this large-scaled lamp is pure and back to basic, therefore the SO1 really leaves nobody untouched. Made in PE (polyethylene) by rotational moulding, this large lamp (height 1m40) can be used inside as well as outside. Built-in into ceiling or wall, lying on the floor or just hanging in the room. Outside used as street light (with a post) or as lighting accent in the garden.

The use of this lighting-object will give an extra accent to rooms, spaces, streets and public parcs.

design by Sara Olaerts.





1/2 SO1



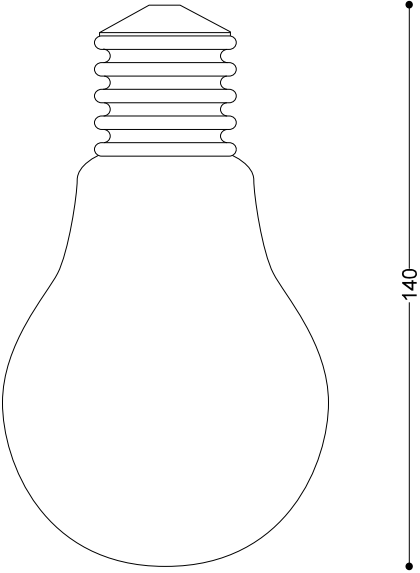

140

°so1

SO1.155.000	SO 1 - 1 x PL55W
SO1.155.DAL	SO 1 - 1 x PL55W DALI controllable
SO1.RGB.DMX	SO 1 RGB LED DMX controllable
SO1.RGB.DAL	SO 1 RGB LED DALI controllable
SO1.RGB.M	SO 1 RGB LED master with remote control
SO1.RGB.S	SO 1 RGB LED slave

materials: PE & steel - weight: 18 kg - 230VAC - max 55W
outdoor use on request - included : 2 m cable, rosas and suspension element

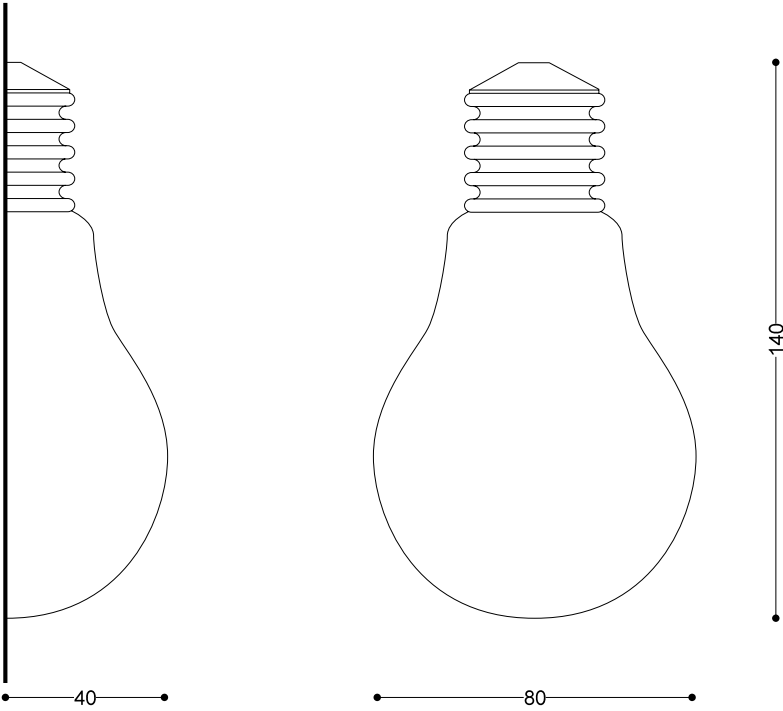

40

80

140

°1/2 so1

SO1.155.1/2	1/2 SO 1 with 1 x PL55W
SO1.155.1/2.DAL	1/2 SO 1 with 1 x PL55W DALI controllable

materials: PE & steel - weight: 10 kg - 230VAC - max 55W
outdoor use on request



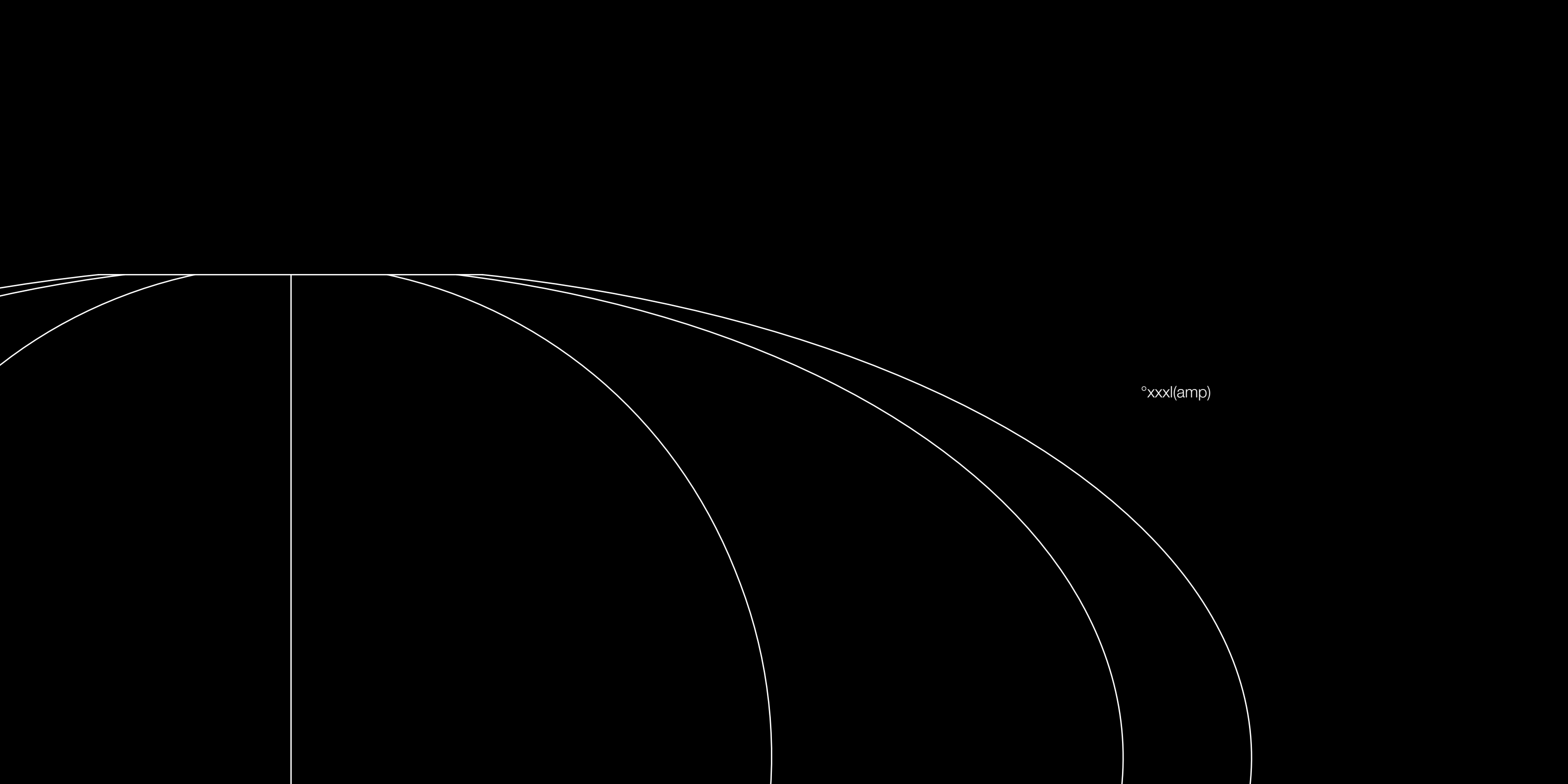

°xxxl(amp)

Perhaps symptomatic of an architect's mindset, the lamps and objects are becoming increasingly 'space defining'. The xxxl(amp) is essentially a flattened dome, inspired by the shape of a Chinese lantern. The twelve-segment construction makes the connection with the lantern, but a pumpkin is perhaps the first association that comes to mind, while the suspension system recalls an upside-down hot-air balloon.

If the ceiling is high, but not overly high, the lamp can be hung at about 1.50m. As befits any impressive space, you'll want to enter with a slight bow. Once seated at the dining or conference table, you'll still retain a sense of the surroundings beyond the boundary.

Hanging a half or a quarter xxxl(amp) in a mirrored room creates an impression of spacious rooms full of giant lanterns.

design by Bart Lens.









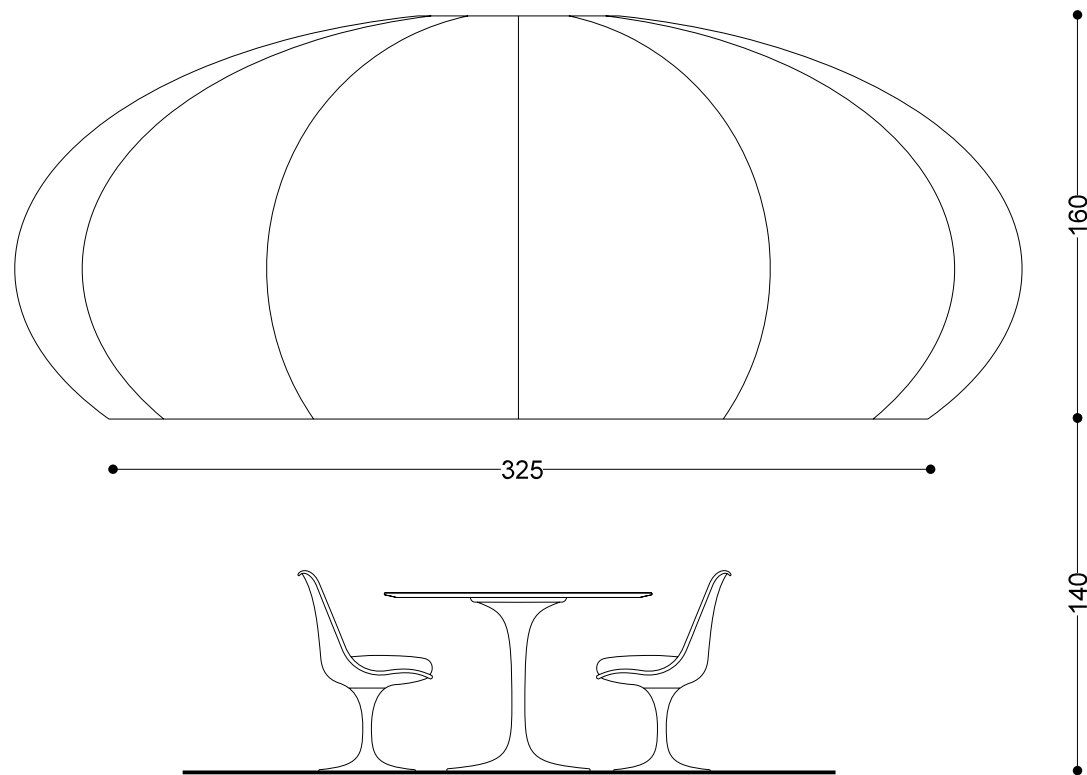

°xxxl(amp)

XXXL.327.000	XXXLamp standard 3 x E27 - excl lamps
XXXL.327.RGB.M	XXXLamp 3 x E27 socket + RGB LED master + remote control
XXXL.327.RGB.S	XXXLamp 3 x E27 socket + RGB LED slave
XXXL.327.RGB.DMX	XXXLamp 3 x E27 socket + RGB LED DMX controllable
XXXL.327.RGB.DAL	XXXLamp 3 x E27 socket + RGB LED DALI controllable

material: PE - weight: 355 kg - 230VAC - max 1500W
included : 4 m cables & 12 suspension elements, lighting element with 2 m suspesion bar.

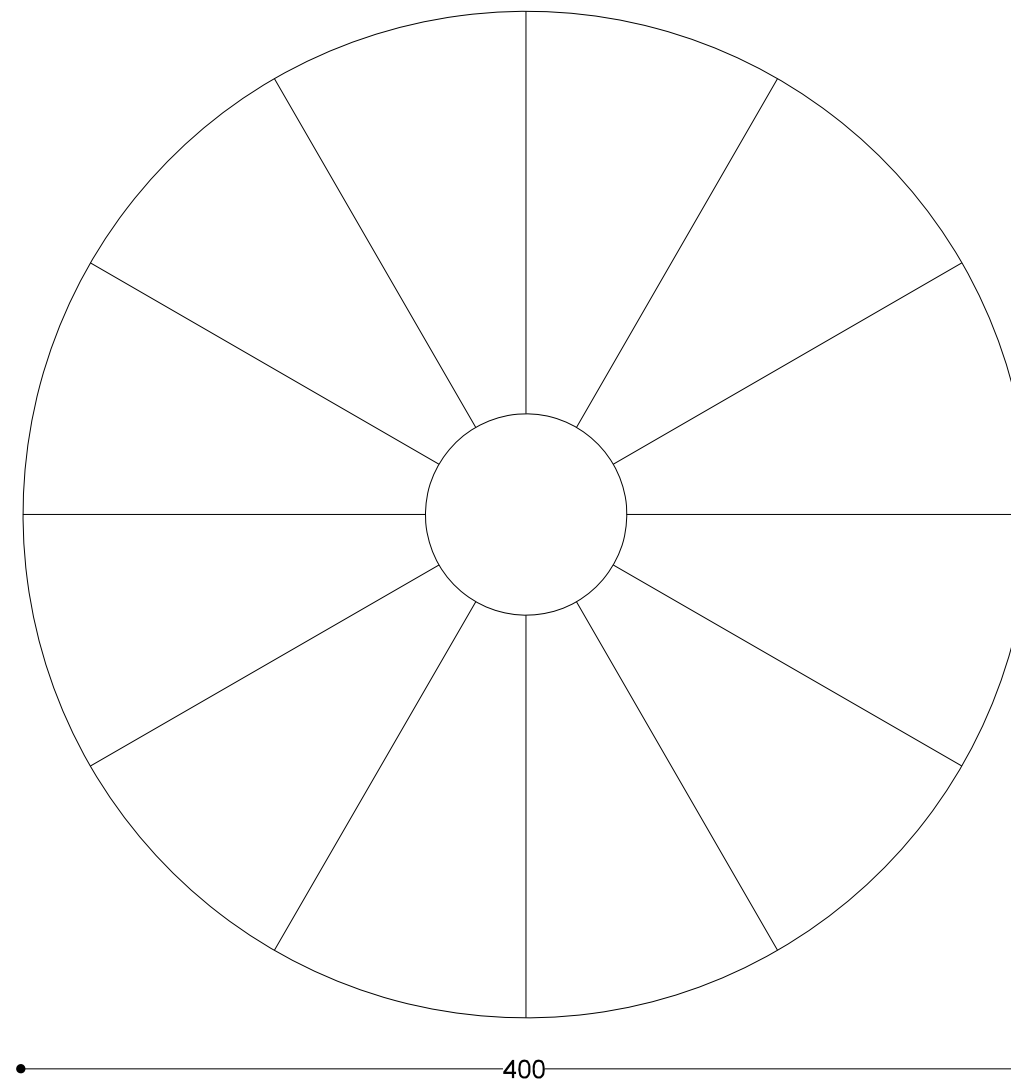

This lamp was initially designed to mark the edge of a fair booth and simultaneously present images on the inside. The lamp shade foil is foldable. This allows for easy transport and makes it possible to cover the lamp with a photo film. The lamp, by virtue of its size, defines its own space.

design by Bart Lens.









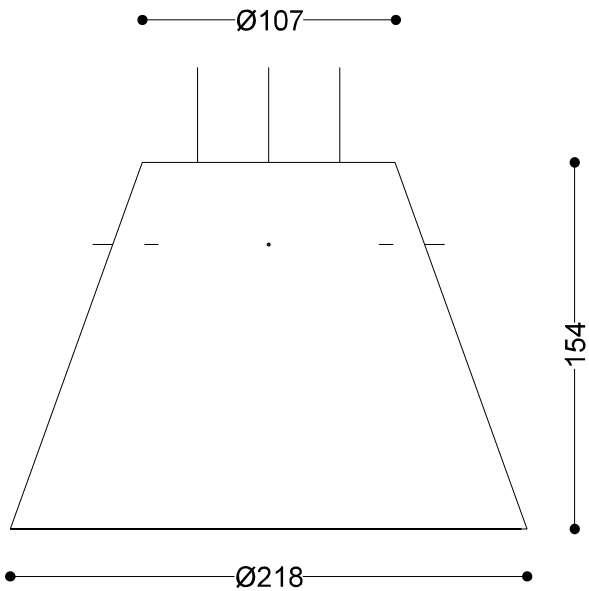

large

°xl(amp) large

XL.154.127.000	Xlamp h 154 1 x E27 socket - excl lamp
XL.154.127.RGB.M	Xlamp h 154 1 x E27 socket + RGB LED Master on remote - excl lamp
XL.154.127.RGB.S	Xlamp h 154 1 x E27 socket + RGB LED Slave - excl lamp
XL.154.127.RGB.DMX	Xlamp h 154 1 x E27 socket + RGB LED DMX controllable - excl lamp
XL.154.127.RGB.DAL	Xlamp h 154 1 x E27 socket + RGB LED DALI controllable - excl lamp

material: polyester - weight: max 34 kg - included : 2 m cable, rosas, 3 suspension elements - 230VAC - max 1000W

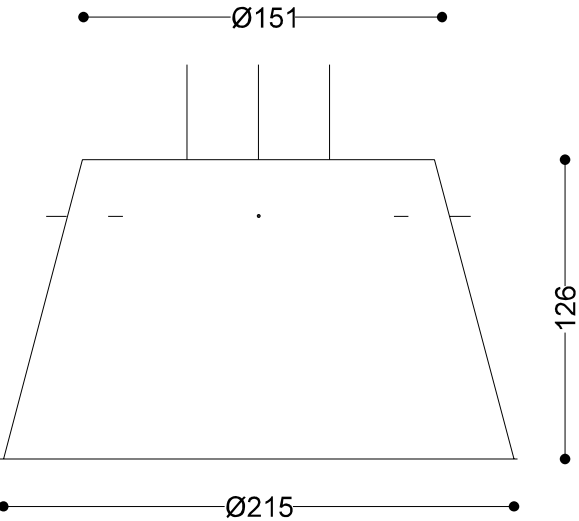

small

°xl(amp) small

XL.126.127.000	Xlamp h126 1 x E27 - excl lamp
XL.126.127.RGB.M	Xlamp h126 1 x E27 socket + RGB LED Master with remote control - excl lamp
XL.126.127.RGB.S	Xlamp h126 1 x E27 socket + RGB LED slave - excl lamp
XL.126.127.RGB.DMX	Xlamp h126 1 x E27 socket + RGB LED DMX controllable - excl lamp
XL.126.127.RGB.DAL	Xlamp h126 1 x E27 socket + RGB LED DALI controllable - excl lamp

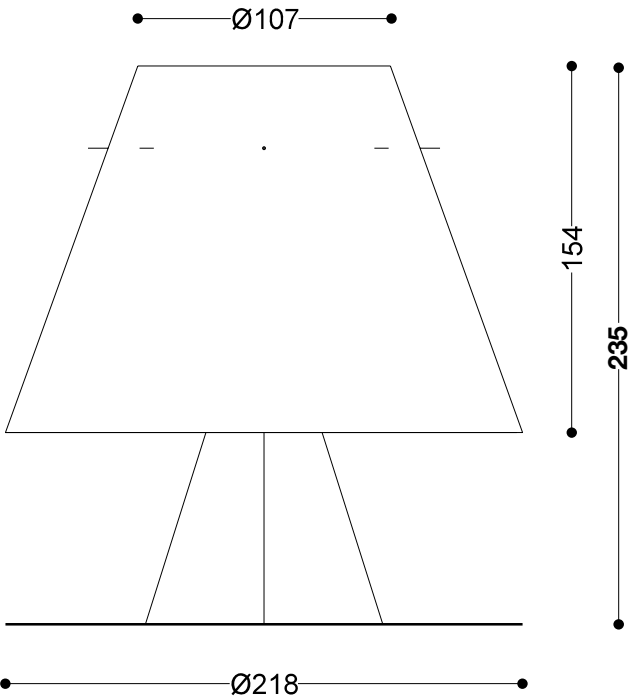

°xl(amp) floor

XL.154.127.FLR	Xlamp h 235 1xE27 socket floor - excl lamp
----------------	--

material: polyester & steel - weight 36 kg - included : 2 m cable - 230VAC - max 1000W



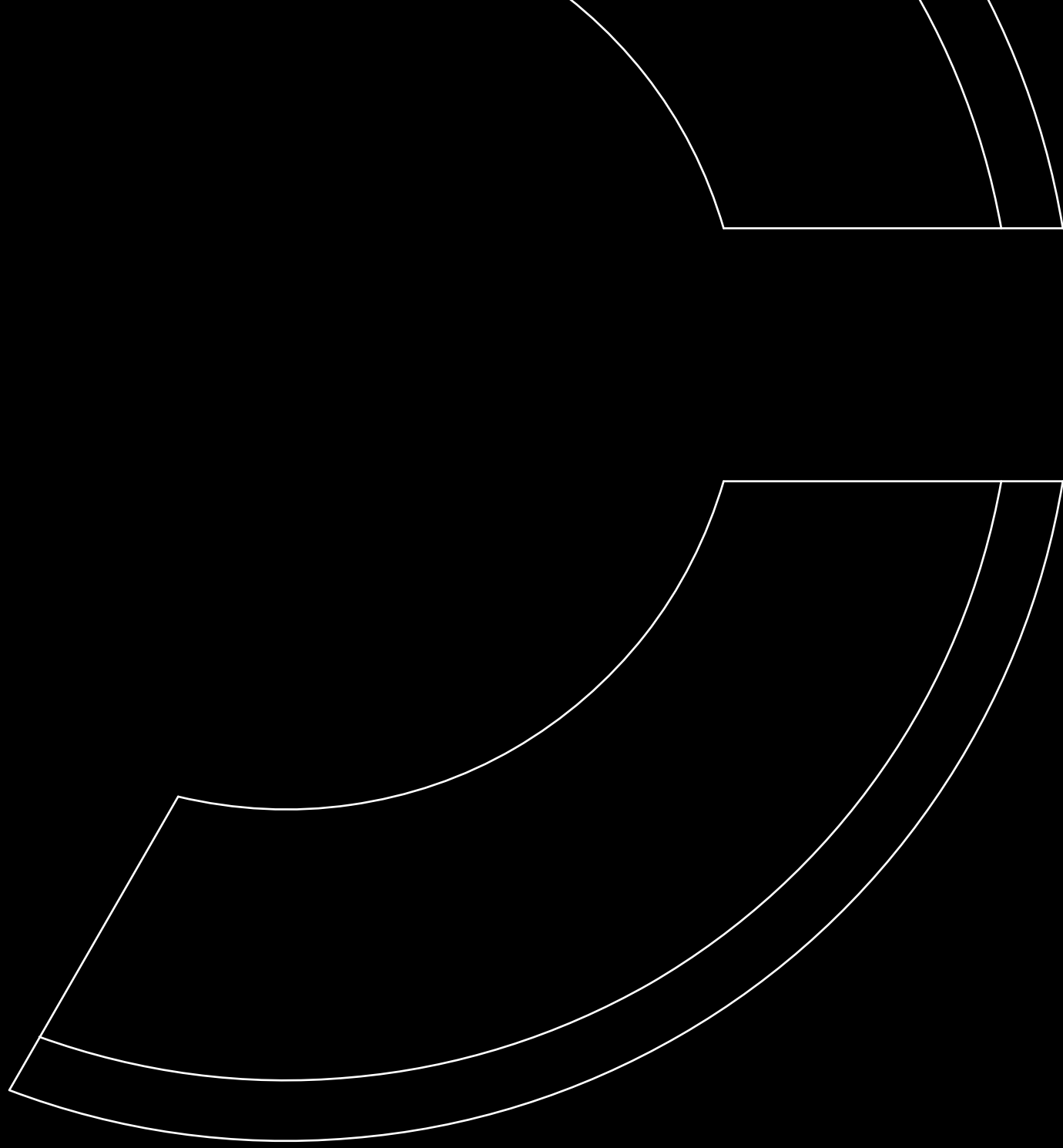
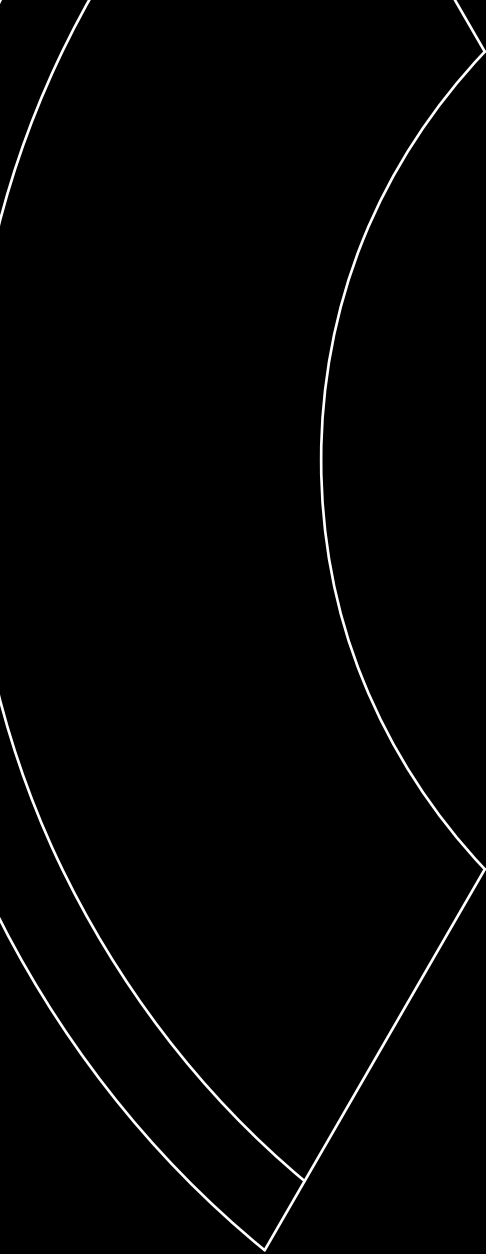

°xl seating



3 piece seating, set at a distance suitable for communication, situated centrally underneath, and an extension of the form of the lighting element above, the XL(amp).

design by Bart Lens.



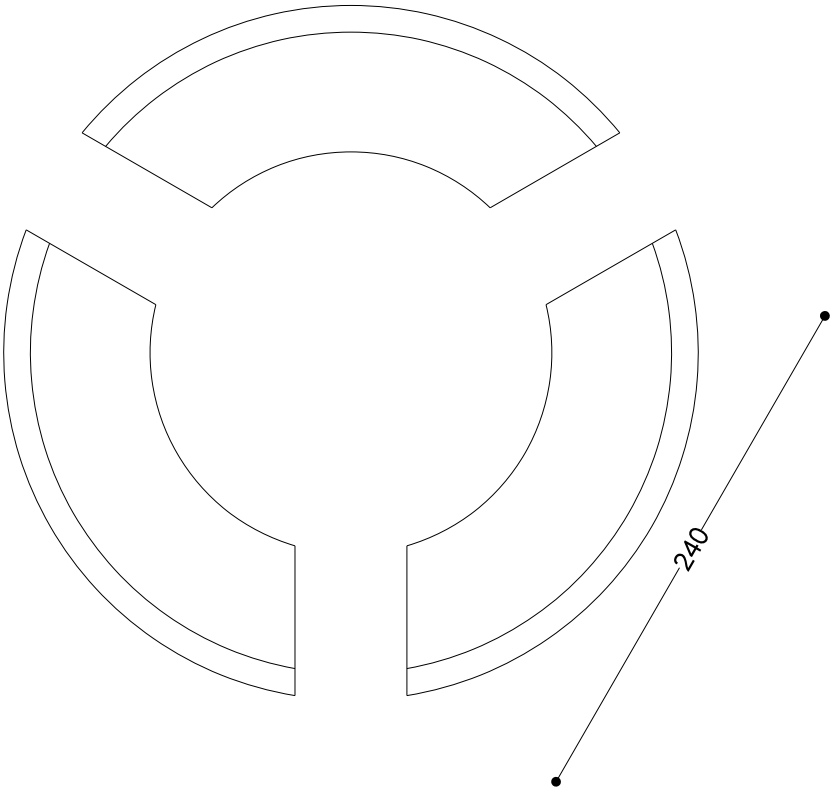
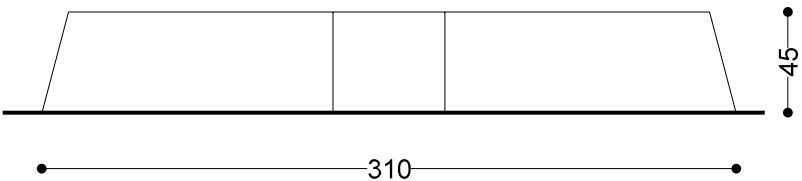

°xl seating

XL.SEAT

XL seating

materials: foam with elastic coating - weight: 20,5 kg - indoor and outdoor use

A synthetic drape forms a covered table and at the same time a table structure. Entirely resembling a starched hail blank tablecloth, but manufactured in self-supporting blank plastic. Optionally, rechargeable light modules are available so that the tables can be placed wireless everywhere. After seven hours the tables announce the end of the party. Time to recharge!

design by Bart Lens.







°tablecloth

- | | |
|-------------|---|
| TCL.000 | tablecloth |
| TCL.127 | tablecloth 1 x E27 socket + 2 m cable - excl lamp |
| TCL.LED.B | tablecloth with white LEDs + battery-charger |
| TCL.RGB.B | tablecloth with RGB LEDs + battery-charger + remote control |
| TCL.RGB.C | tablecloth with RGB LEDs + cable + remote control |
| TCL.RGB.DMX | tablecloth with RGB LEDs, DMX controllable |
| TCL.TR.000 | tablecloth transparant |

material: PMMA - weight: 23,5 kg - 230VAC - max 100W

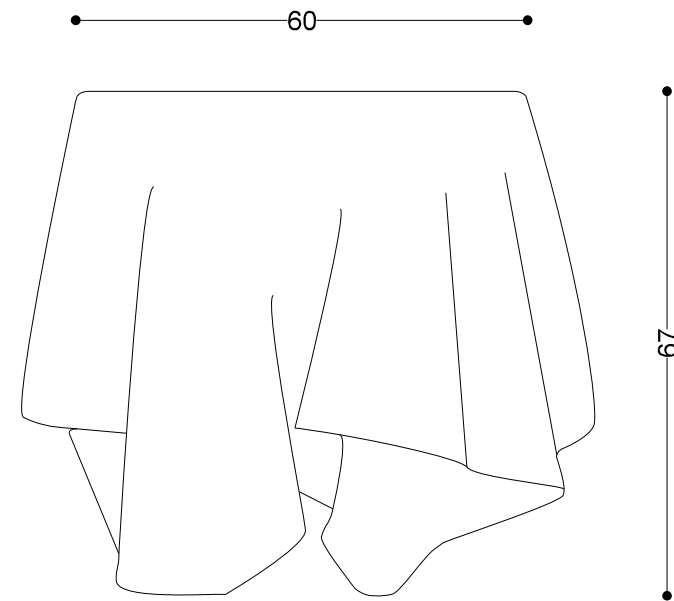

°tablecloth low

- | | |
|---------------|---|
| TCL.L.000 | tablecloth low |
| TCL.L.127 | tablecloth low 1 x E27 socket + 2m cable - excl lamp |
| TCL.L.LED.B | tablecloth low with white LEDs + battery-charger |
| TCL.L.RGB.B | tablecloth low with RGB LEDs + battery-charger + remote control |
| TCL.L.RGB.C | tablecloth low with RGB LEDs + cable + remote control |
| TCL.L.RGB.DMX | tablecloth low with RGB LEDs, DMX controllable |
| TCL.L.TR.000 | tablecloth low transparant |

material: PMMA - weight: 13 kg - 230VAC - max 100W



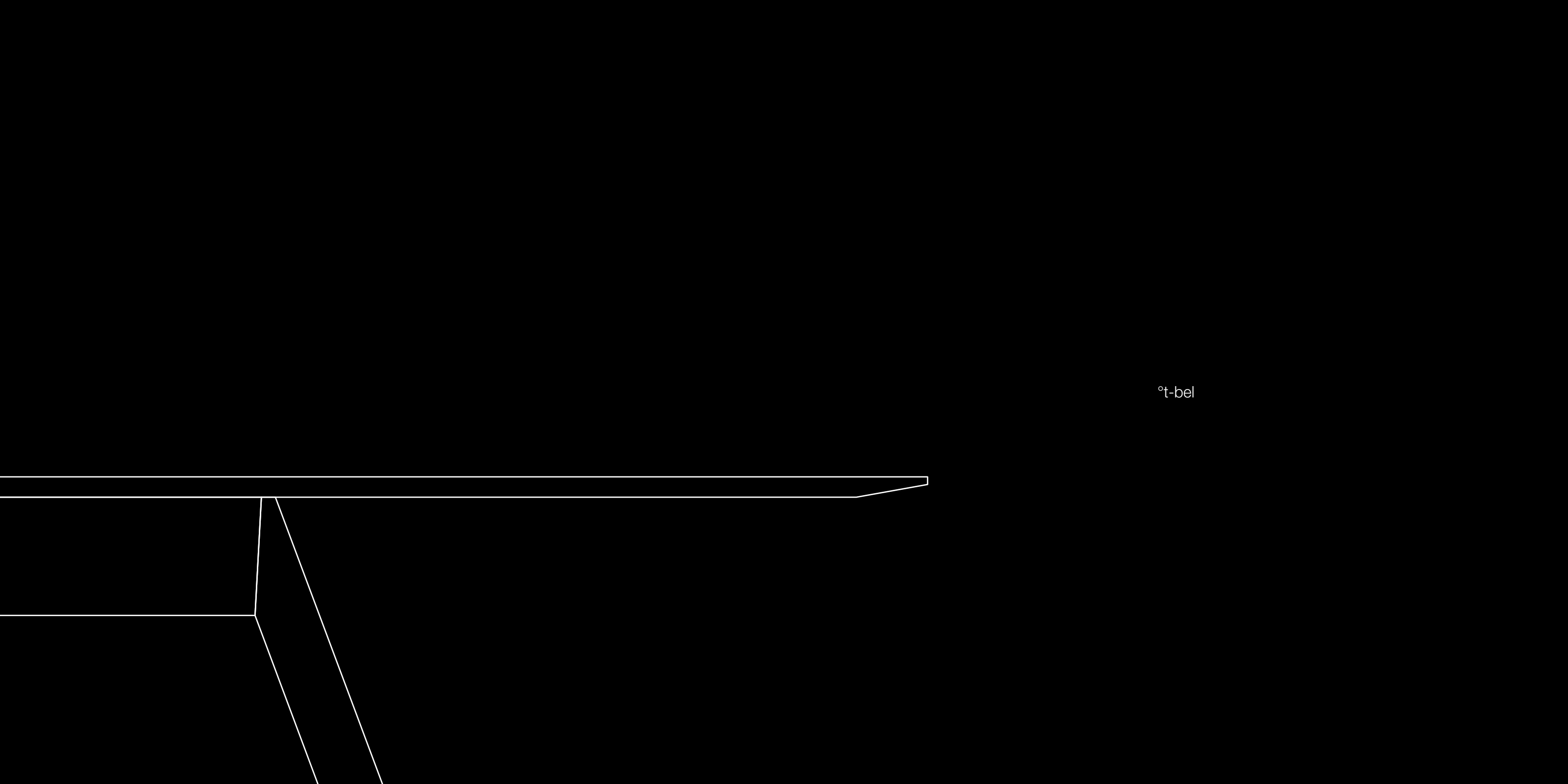

°t-bel

The table shares the standard dimensions of the panels that we originally used to cover our summer terrace. The steel pedestals, made from extra-fine folded steel, resemble feathers that lift up the tabletop, while the full side panels give some volume to this seemingly weightless table.

design by Bart Lens.





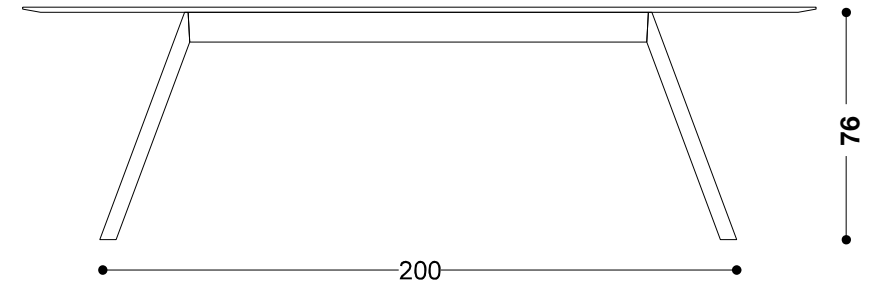
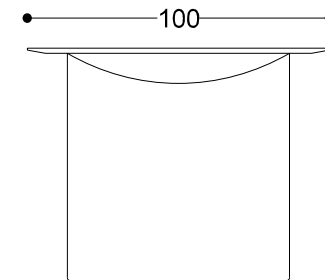

°t-bel

T.BEL.200 Corian Table 2 meter
T.BEL.300 Corian Table 3 meter

materials: galvanised coated steel & corian tabletop - weight (2 m): 115,5 kg - indoor and outdoor use



°deux cheveaux

The round tubular seat on legs refers to the vaulting horse – 'cheval', in French – of the gym room. The 't-bel' table comes with two benches, les deux chevaux (the two horses).

design by Bart Lens.



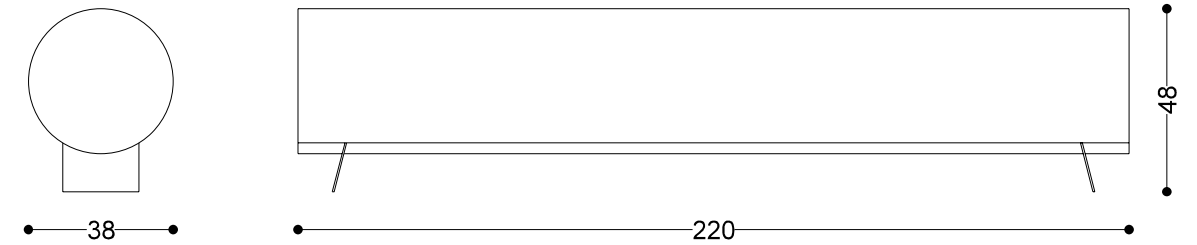
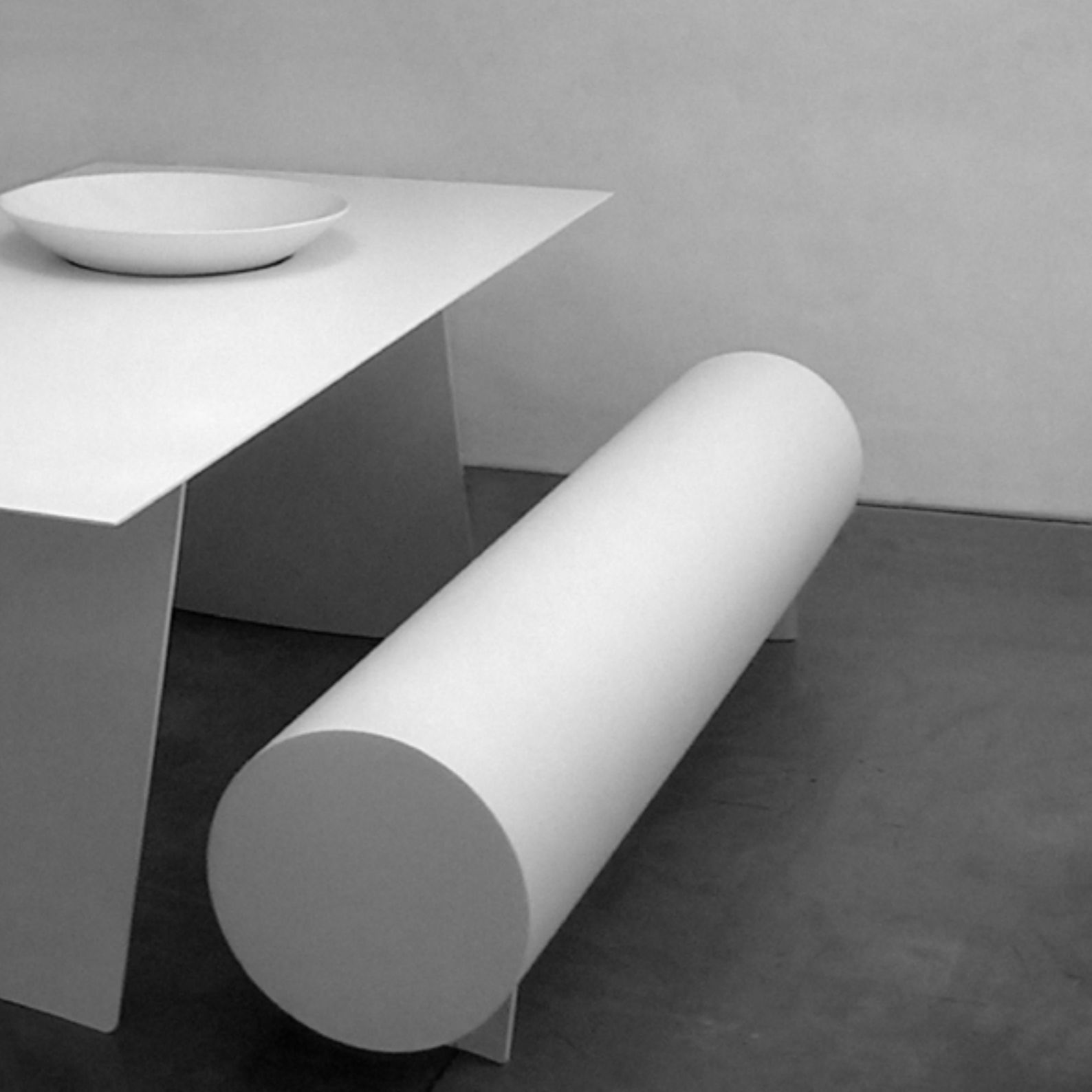

°deux chevaux

2CHEV.220

deux chevaux 220 cm seat + role white

materials: subframe in galvanized and enameled steel, cylinder in foam with elastic coating - weight: 37,5 kg - indoor and outdoor use



°ass-3

'Ass-3, ashtray and ass-tree': the remnant of a fallen tree or tree-stump is used as the archetype of a bench ('ass' and 'tree'), taken to the abstract extreme as a cylindrical container with leg-shaped recesses that, oddly enough, offer the ultimate sitting comfort. Its recesses resemble an ashtray, '3' refers to the third chair of 'Lens'°ass'.

The 'art of sitting' is rediscovered or experienced through the geometrical form, the white color and the ambiguous materials. The double °ass3 allows you to sit either face-to-face or back-to-back, depending on whether you are feeling interested, disinterested or conversational.

design by Bart Lens.





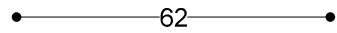
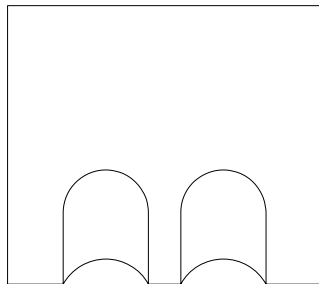
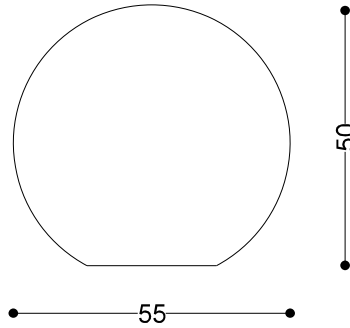
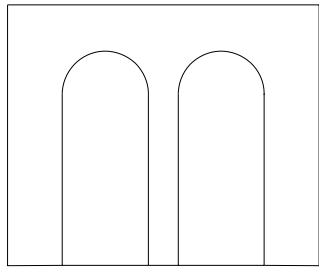

°ass-3 single

ASS3.001

ass-3 single

materials: foam with elastic coating - weight: 5,5 kg - indoor and outdoor use

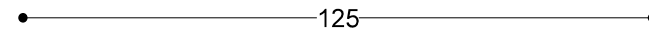
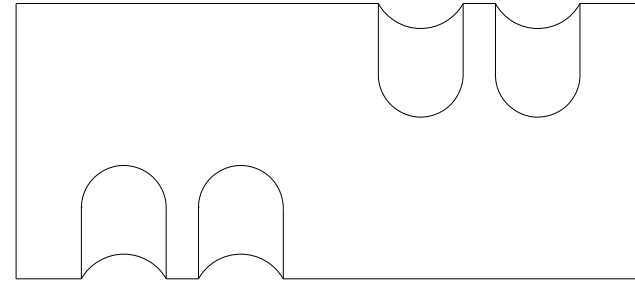
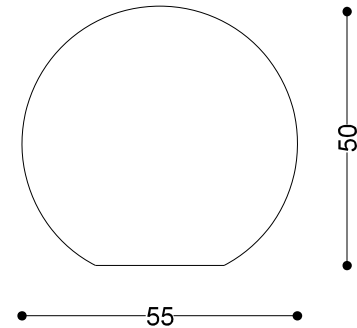
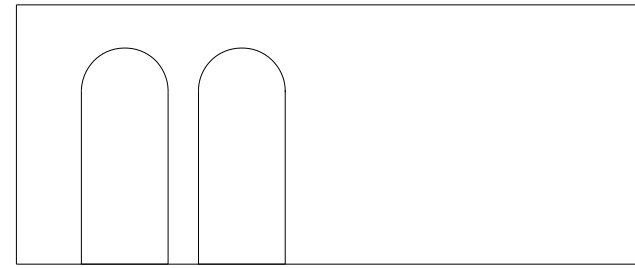

°ass-3 double

ASS3.002

ass-3 double

materials: foam with elastic coating - weight: 11 kg - indoor and outdoor use

To find a white air mattress that fits our white summer terrace, one that can easily be stacked and handled, we looked to our friend Steven Brouns for help. He produced the first sketches for designs in coated foam. Steven created an extra value to the design by using recto-verso forms, which together made up a rectangular volume. Combined, the forms function as a settee or a bench for massages or rubbing suntan lotion onto each other. Once opened up, the forms naturally lie opposite each other. The apparently massive blocks are really lightweights, and can be easily handled by anyone. Both forms, a Z and a soft S shape, can easily be placed side by side.

design by Bart Lens.







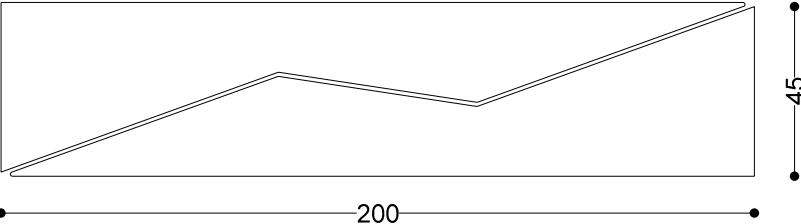
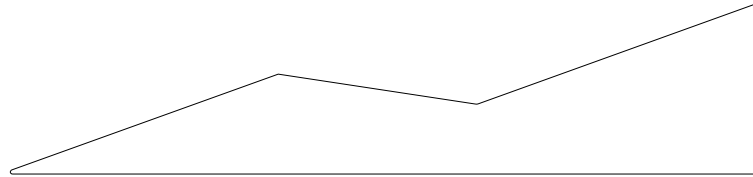
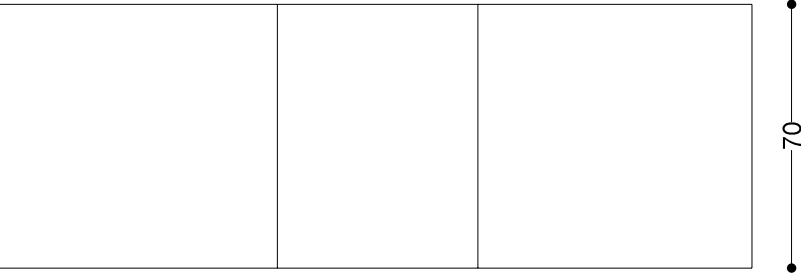

°poolchair straight

PCH.ST poolchair straight model

material: foam with elastic coating - weight: 13 kg - indoor and outdoor use - only sold in pairs

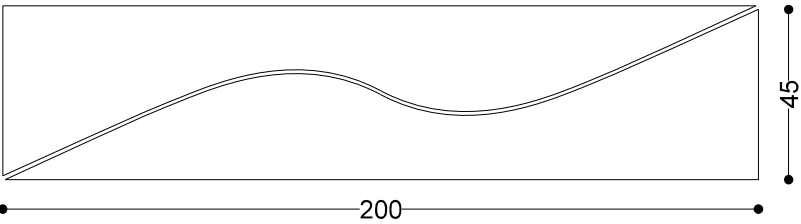
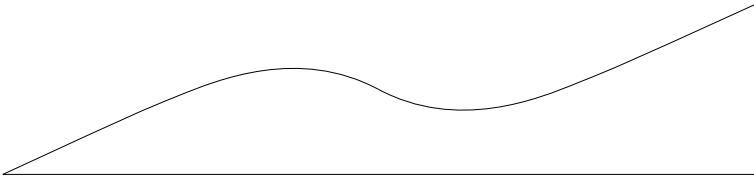
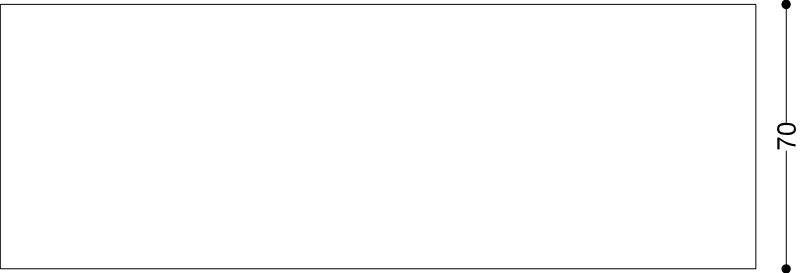

°poolchair curved

PCH.CU poolchair curved model

material: foam with elastic coating - weight: 13 kg - indoor and outdoor use - only sold in pairs